

VALUE PLASTICS BIOPROCESSING

COMPONENTS



TABLE

of Contents

Material Reference	4
Introduction	5
RQ Series Quick Connects	6-7
Spaulding™ Aseptic Disconnects.....	8-9
PharmaLok™ Clamps.....	10-13
BioClamp®	14
BioValve®.....	15
Sanitary Fittings - Mini Flange	16
Sanitary Fittings - Maxi Flange.....	17
Sanitary Fittings - Reducers.....	18-19
Sanitary Fittings - Instrument Tees.....	20
CYLINDRAFlow™ Manifolds.....	21
Gaskets.....	22-23
Bag Ports.....	24-25
Opposing Barb Ports	26-27
Tube Fittings.....	28-51
Luer Fittings	52-53
Needlefree Swabable Valves	54-55
Check Valves	56-59
Stopcocks.....	60-63
Tubing	64-65
Index	66-73

MATERIAL

Reference

-0	Natural Nylon	-6012	Animal-Free Black Polypropylene
-001	Various, see part description	-9002	Radiation Stable Polycarbonate
-06	Orange Nylon	-9010	Radiation Stable Polycarbonate
-07	Yellow Nylon	-9024	Polycarbonate
-1	White Nylon	-CM056	RENOLIT SOLMED Granuflex 4301 Polyethylene
-2	Black Nylon	-E	PTEE/EPDM
-3	Red Nylon	-J1A	Natural Kynar® PVDF
-4	Green Nylon	-J1A2	Natural Kynar® PVDF
-5	Blue Nylon	-PX	Platinum-Cured Silicone
-7	Glass-Filled Natural Nylon	-U706	Orange Class VI Glass-Filled Nylon
-9	Clear Polycarbonate	-U71	White Class VI Glass-Filled Nylon
-10	Acetal	-U75	Blue Class VI Glass-Filled Nylon
-81	Lace White ABS	-VP1	Animal-Free Polyethylene
-6005	Animal-Free Polypropylene	-XO	Stainless Steel

Founding Member BPSA - Bio-Process Systems Alliance

BPSA is a unique industry-led non-profit group whose aim is to encourage and advance the adoption and implementation of single-use manufacturing systems through education, sharing of best practices, development of consensus guidelines and business-to-business networking opportunities. Nordson MEDICAL is a participating member of BPSA and is also represented on the Executive Board.



Bio-Process Systems Alliance

Advancing Single-Use Worldwide

Nordson MEDICAL

Nordson MEDICAL is your partner in the global life sciences market. We offer a wide range of capabilities, services, and customized OEM solutions.

Nordson MEDICAL is backed by the extensive resources of Nordson Corporation (Nasdaq: NDSN), the world leader in precision dispensing, fluid management and related technologies.

About the VP Product Line

The Value Plastics product line includes over 5,000 fluid management components designed specifically for flexible tubing in different style and material combinations. Products include bioprocessing fittings, quick connect fittings, luer fittings, check valves, tube-to-tube fittings, and TC fittings with tubing IDs ranging from 1/16" to 1". We also offer custom component manufacturing, tubing, and select OEM components. The Value Plastics product line finds global application in demanding pharmaceutical and healthcare OEMs, research and specialty industrial applications.

Specialists in Pharmaceutical Development

Nordson MEDICAL serves biotechnology manufacturers the world over. Whether they happen to manufacture therapeutics or vaccines, Nordson MEDICAL provides world-class single-use fluid transfer components to facilitate breakthrough advances in human and animal care pharmaceutical development.

Systems Integration

Bioprocessing system integrators rely on quality fluid management components from Nordson MEDICAL. Nordson MEDICAL is a one-stop-shop and delivers unmatched standards-specific components time and again that are guaranteed to interconnect within any bioprocessing system regardless of the supplier. Our extensive product family can grow with you from pre-clinical to full-scale commercial products.

High-Purity Resins

Made from high-purity resin materials for use with aggressive chemicals found in most pharmaceutical manufacturing plants, our plastic connectors offer broad chemical compatibility. Resins that are free of animal derivatives and adhere to standards such as ISO 10993 and USP Class VI, for example, are particularly important in biopharmaceutical applications.

Validation Packages

Nordson MEDICAL performs resin and product tests, reducing the amount of testing required by our customers and aiding them in determining what level of tests they do need to perform. You can request extractables test data from our website, www.nordsonmedical.com.

Your Trusted Source

Nordson MEDICAL is your trusted source for bioprocessing products, offering regulatory information, part drawings, extractables data, biocompatibility data, and validation test data.

We provide a comprehensive design center to help instrumentation and equipment manufacturers achieve the highest level of performance from their applications. Offering off-the-shelf or custom-made products, optimal designs are executed producing reliable and cost-effective results that comply with the industry's strict regulations. Nordson MEDICAL also offers a full quality assurance staff who are available to assist when regulatory and technical questions arise.

Contact us to learn more about our bioprocessing capabilities.
TEL: +1 (970) 267-5200
TOLL FREE in USA: (888) 404-5837
www.nordsonmedical.com

RQSeries

Quick Connects

Nordson MEDICAL has developed a more robust alternative for bioprocessing needs with the RQC Series and RQX Series offering a cost effective solution for flexible tubing connections in single use systems. The connector set is best in fit, form and function, and features a user-friendly interface that includes a large guarded button for a secure lock to guard against disconnects, and lofted lead-in for improved ease of connection. The more reliable locking feature gives you peace of mind knowing your connection is secure.



RQCF655 (-9024 -001)
RQCF655 (-6005 -001)
Female Open Flow, 600 Series Barb,
1/4" (6.4 mm) Tubing ID



RQCF670 (-9024 -001)
RQCF670 (-6005 -001)
Female Open Flow, 600 Series Barb,
3/8" (9.5 mm) Tubing ID



RQCF (-9024 -001)
RQCF (-6005 -001)
Female Cap



RQCM655 (-6005 -001)
Male Open Flow, 600 Series Barb,
Platinum-Cured Silicone O-Ring,
1/4" (6.4 mm) Tubing ID



RQCM670 (-9024 -001)
RQCM670 (-6005 -001)
Male Open Flow, 600 Series Barb,
Platinum-Cured Silicone O-Ring,
3/8" (9.5 mm) Tubing ID



RQCM (-6005 -001)
Male Plug, Platinum-Cured Silicone
O-Ring



RQCFLC (-9024 -001)
Female Cap, Locking Feature

Features & Benefits:

- Materials meet USP Class VI & ISO 10993 criteria
- Several connector configurations available in commonly used polypropylene & polycarbonate materials
- Large ergonomic button & thumb pad with secure latch & optional integrated locking mechanism
- Platinum-cured silicone o-rings
- Plugs & caps available to maintain fluid path integrity
- Supports cryogenic applications to -60°C
- Interworks with other similar quick connects found in the market

Specifications:

Materials:

- Polypropylene (-6005-001)
- Tinted Polycarbonate (-9024-001)

Sterilization:

- Gamma radiation stable, EtO compatible, autoclavable to 121°C for up to 20 minutes

Testing:

- Bioburden, Cytotoxicity, Extractables

RQC Series Tubing Sizes:

- 1/4" (6.4 mm) and 3/8" (9.5 mm) tubing IDs

RQX Series Tubing Sizes:

- 3/8" (9.5 mm) and 1/2" (12.7 mm) tubing IDs



RQXF670 (-9024 -001)
RQXF670 (-6005 -001)
Female Open Flow, 600 Series Barb,
3/8" (9.5 mm) Tubing ID



RQXF680 (-6005 -001)
Female Open Flow, 600 Series Barb,
1/2" (12.7 mm) Tubing ID



RQXFC (-6005 -001)
Female Cap

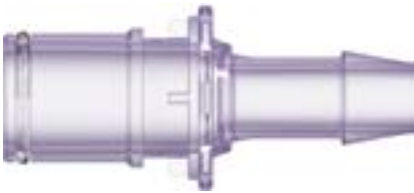

RQXM670 (-9024 -001)
Male Open Flow, 600 Series Barb,
Platinum-Cured Silicone O-Ring,
3/8" (9.5 mm) Tubing ID



RQXM680 (-6005 -001)
Male Open Flow, 600 Series Barb,
Platinum-Cured Silicone O-Ring,
1/2" (12.7 mm) Tubing ID



RQXMP (-9024 -001)
RQXMP (-6005 -001)
Male Plug, Platinum-Cured Silicone
O-Ring

SPAULDING™

Aseptic Disconnects

Providing a leak-free connection, the Spaulding™ Series Aseptic Disconnects eliminate the need for pinch clamps and tube welders. Smooth disconnects are achievable with the easy-to-use design, and valuable fluids are protected by valves that automatically shut off flow when the fittings are disconnected. Available in USP Class VI, ADCF Polysulfone, validation and test results confirm their suitability in pre-sterilized systems and are also gamma radiation stable. These connectors are interchangeable with similar plastic connectors.



SDAVF655NPS (-001)

Female Valved Aseptic Connector, 600 Series Barb,
1/4" (6.4 mm) Tubing ID



SDAVF670NPS (-001)

Female Valved Aseptic Connector, 600 Series Barb,
3/8" (9.5 mm) Tubing ID



SDAM655NPS (-001)

Male Open Flow Aseptic Connector, 600 Series Barb,
1/4" (6.4 mm) Tubing ID



SDAM670NPS (-001)

Male Open Flow Aseptic Connector, 600 Series Barb,
3/8" (9.5 mm) Tubing ID



SDAVM655NPS (-001)

Male Valved Aseptic Connector, 600 Series Barb,
1/4" (6.4 mm) Tubing ID



SDAVM670NPS (-001)

Male Valved Aseptic Connector, 600 Series Barb,
3/8" (9.5 mm) Tubing ID

Features & Benefits:

- Valves that automatically shut off flow at disconnection
- Interchangeable with other plastic & metal connectors
- Plugs and caps available to maintain fluid path integrity
- Made with BSE/TSE-free materials
- Validation and test results confirm their suitability in pre-sterilized systems
- Materials satisfy USP Class VI criteria
- Fittings meet industry requirements
- Aseptic disconnect operation

Specifications:

Materials:

- Body - USP Class VI, ADCF tinted polysulfone
- O-Rings - Platinum-cured, silicone
- Springs - 316 stainless steel

Sterilization:

- Gamma radiation stable up to 50kGy, autoclavable to 270°F (132°C) for a maximum of 60 minutes

Fits Tubing IDs:

- 1/4" (6.4 mm), 3/8" (9.5 mm), 1/2" (12.7 mm)

Operating Temperature:

- -40°F (-40°C) to 280°F (138°C)

Leak Resistance:

- 125 psi, 8.62 bar



SDAVF680NPS (-001)

Female Valved Aseptic Connector, 600 Series Barb, 1/2" (12.7 mm) Tubing ID



SDAFCNPS (-001)

Female Cap Aseptic Connector



SDAM680NPS (-001)

Male Open Flow Aseptic Connector, 600 Series Barb, 1/2" (12.7 mm) Tubing ID



SDAMPNPS (-001)

Male Plug Aseptic Connector



SDAVM680NPS (-001)

Male Valved Aseptic Connector, 600 Series Barb, 1/2" (12.7 mm) Tubing ID

PHARMATMLok

Clamps

Offering full flexibility in single-use applications, Nordson MEDICAL has developed ground-breaking clamp designs that simplify the assembly process by making it effortless to securely attach sanitary fittings to bag ports and filters. PharmaLok™ clamps are lightweight, easy to install, and feature a quick release. The clamps are specifically designed to meet the needs of busy pharmaceutical and bioprocessing laboratories and work with Nordson MEDICAL's SF Series sanitary fitting Mini and Maxi flanges, as well as related caps and gaskets. Nordson MEDICAL's PharmaLok™ clamps are ASME BPE compliant and operate at a maximum pressure of 80 psi.

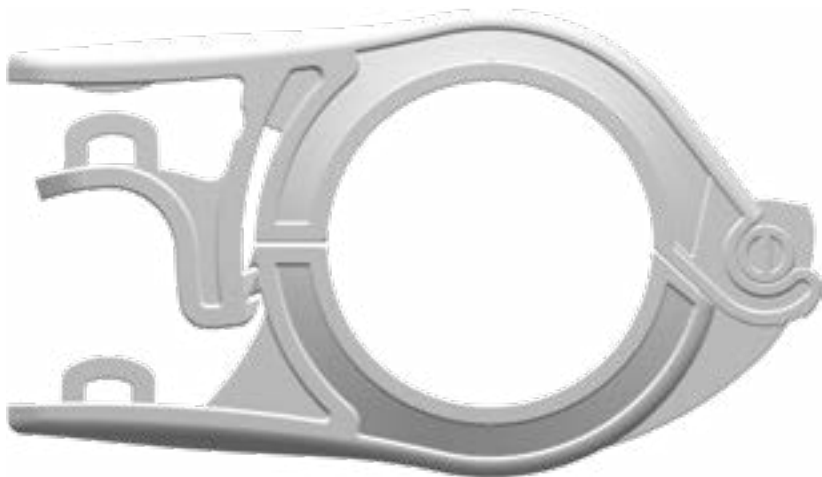

CPAX150 (-U71)

PharmaLok™ Easy-Open Clamp Series, Hygienic Union TC Version
1" (25.4 mm) to 1.5" (38.1 mm), Glass Reinforced White Nylon



CPAN75 (-U71)

PharmaLok™ Easy-Open Clamp Series, Hygienic Union TC Version
.5" (12.7 mm) to .75" (19.0 mm), Glass Reinforced White Nylon



CPAX150 (-U75)

PharmaLok™ Easy-Open Clamp Series, Hygienic Union TC Version
1" (25.4 mm) to 1.5" (38.1 mm), Glass Reinforced Blue Nylon



CPAN75 (-U75)

PharmaLok™ Easy-Open Clamp Series, Hygienic Union TC Version
.5" (12.7 mm) to .75" (19.0 mm), Glass Reinforced Blue Nylon

Single-Use Clamps & Easy-Open Clamps Features & Benefits:

- ASME BPE 18 DT-7-1 compliant & DIN compliant
- Easy to use, one-handed closure - no tools needed
- Repeatable use with constantly equal pressure on the gasket
- Tamper evident & zip tie compatible
- 360° compression
- Connects both plastic & stainless steel fittings
- SIP/CIP compatible

Single-Use Clamps & Easy-Open Clamps Specifications:

Materials:

- USP Class VI & ISO 10993 certified glass-filled nylon

Temperature & Sterilization Specifications:

- Normal operating temperature -94°F (-70°C) to 140°F (60°C)
- Cryogenic freezing to -112°F (-80°C)
- Autoclavable up to 273°F (134°C) for a maximum of 30 min.
- Gamma radiation up to 50 kGy

Maximum Pressure:

- 80 psi (conforms to ASME BPE-2014 PM-4.2.2)

Sizes:

- Fitting .5" (12.7 mm) to .75" (19.0 mm) and 1" (25.4 mm) to 1.5" (38.1 mm)



CPAX150 (-U706)

PharmaLok™ Easy-Open Clamp Series, Hygienic Union TC Version
1" (25.4 mm) to 1.5" (38.1 mm), Glass Reinforced Orange Nylon



CPAN75 (-U706)

PharmaLok™ Easy-Open Clamp Series, Hygienic Union TC Version
.5" (12.7 mm) to .75" (19.0 mm), Glass Reinforced Orange Nylon

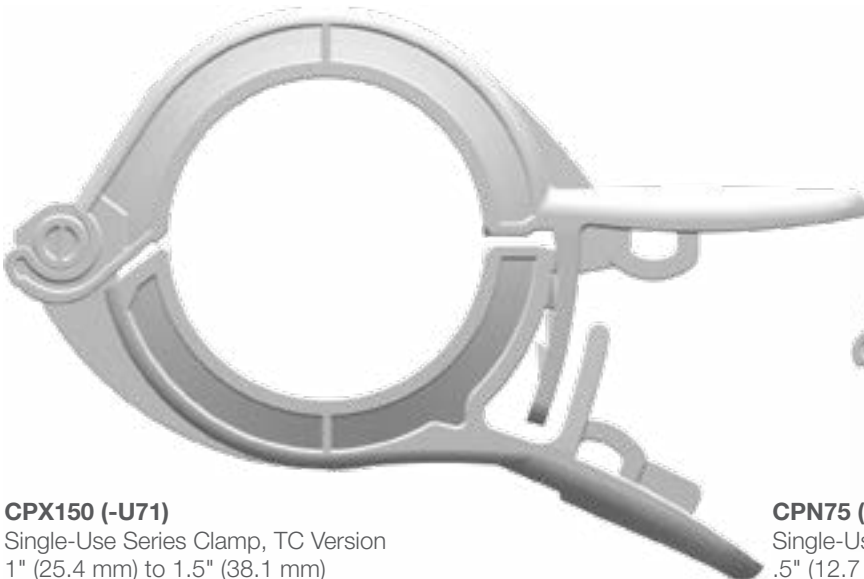

CPX150 (-U71)

Single-Use Series Clamp, TC Version
1" (25.4 mm) to 1.5" (38.1 mm)

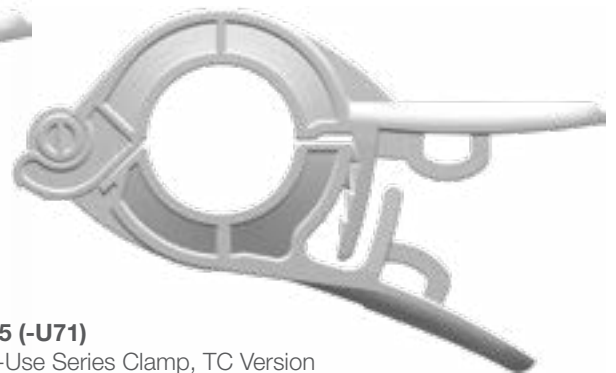

CPN75 (-U71)

Single-Use Series Clamp, TC Version
.5" (12.7 mm) to .75" (19.0 mm)

PHARMATMLok

Tube Clamps

Pharmalok™ tube clamps effortlessly and securely close off flow. Thin-walled tube clamps fit wall thicknesses 1/32" (0.79 mm) to 3/32" (2.38 mm) with a maximum OD of 1/2" (12.7 mm). Tube clamps fit wall thicknesses 1/8" (3.2 mm) to 1/4" (6.4 mm) with a maximum OD of 1" (25.4 mm). Large tube clamps fit wall thicknesses 1/8" (3.2 mm) to 1/4" (6.4 mm) with a maximum OD of 2.5" (63.5 mm).

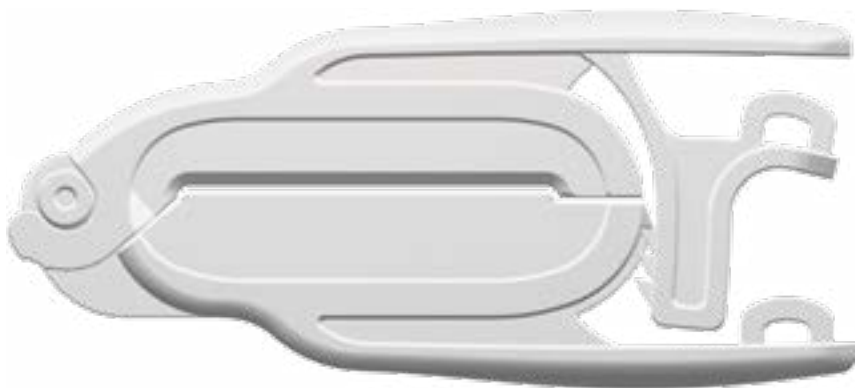

CPT90 (-U71 -U706)

PharmaLok™ Small and Thin-Walled Tube Clamp, Wall Thickness 1/32" (0.79 mm) to 3/32" (2.4 mm), Max OD 1/2" (12.7 mm), Glass-Filled White Nylon or Glass-Reinforced Orange Nylon

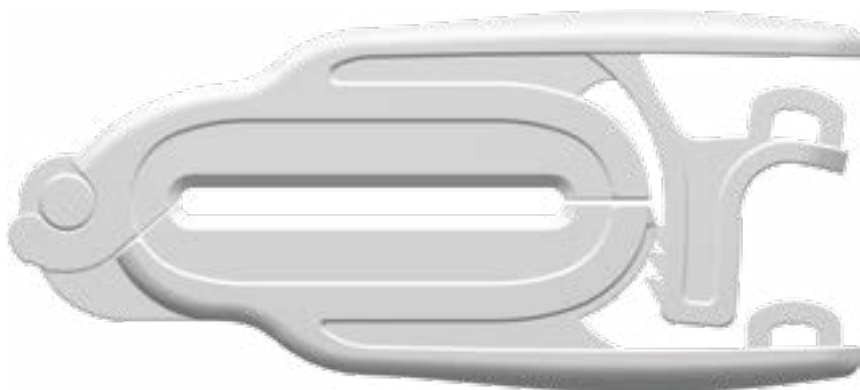

CPT100 (-U71 -U706)

PharmaLok™ Tube Clamp, Wall Thickness 1/8" (3.2 mm) to 1/4" (6.4 mm), Max OD 1" (25.4 mm), Glass-Filled White Nylon or Glass-Reinforced Orange Nylon

Tube Clamps Features & Benefits:

- Designed for use with silicone & TPE tubing
- Easy to use, one-handed closure - no tools needed
- Tamper evident & zip tie compatible

Tube Clamps Specifications:

Materials:

- USP Class VI & ISO 10993 certified glass-filled nylon

Temperature & Sterilization Specifications:

- Normal operating temperature -94°F (-70°C) to 140°F (60°C)
- Cryogenic freezing to -112°F (-80°C)
- Autoclavable up to 273°F (134°C) for a maximum of 30 min.
- Gamma radiation up to 50 kGy

Maximum Pressure:

- Up to 150 psi

Sizes:

- Thin-walled, tube clamp, and large sizes



CPT110 (-U71 -U706)

PharmaLok™ Large Tube Clamp, Wall Thickness 1/8" (3.2 mm) to 1/4" (6.4 mm), Max OD 2.5" (63.5 mm), Glass-Filled White Nylon or Glass-Reinforced Orange Nylon

Need it Fast?

You can order any of our 5,000+ parts online now with no order \$ minimums, 24 hours a day, 7 days a week!
www.nordsonmedical.com

BIOClamp®

BioClamp® plastic quick-release clamps are specifically designed to meet the needs of busy pharmaceutical and bioprocessing laboratories, offering full flexibility in single-use applications. The clamps are lightweight, easy for technicians to install, and provide for convenient assembly release. BioClamps® reduce the distortion on polymeric components when subjected to heat, and the glass reinforced nylon is USP Class VI certified.

Features & Benefits:

- Can be SIP repeatedly
- Can be autoclaved repeatedly at 134°C for 5 minutes
- Reduced distortion on polymeric components
- More compatible with current manufacturing than steel
- Greater flexibility in operation
- Single-use disposal

Specifications:

Materials:

- Glass reinforced nylon 66
- USP Class VI certified

Maximum Operating Pressure:

- 150 psig for 1/2" to 4" clamps
- 90 psig for 6" and 8" clamps

Maximum Cumulative Gamma Dose:

- 40 kiloGrays



Reference Part Shown:
VNG150WHT

VNG075WHT

Clamp, Mini Flange, Glass Reinforced White Nylon, 1/2" (12.7 mm) to 3/4" (19.0 mm) Tubing ID

VNG150WHT

Clamp, Maxi Flange, Glass Reinforced White Nylon, 1" (25.4 mm) to 1.5" (38.1 mm) Tubing ID

VNG200WHT

Clamp, Maxi Flange, Glass Reinforced White Nylon, 2" (50.8 mm) Tubing ID

VNG300WHT

Clamp, Maxi Flange, Glass Reinforced White Nylon, 3" (76.2 mm) Tubing ID

VNG400WHT

Clamp, Maxi Flange, Glass Reinforced White Nylon, 4" (101.6 mm) Tubing ID

VNG600WH

Clamp, Maxi Flange, Glass Reinforced White Nylon, 6" (152.4 mm) Tubing ID

VNG800WH

Clamp, Maxi Flange, Glass Reinforced White Nylon, 8" (203.2 mm) Tubing ID

BIOValve®

The BioValve® pinch valve is a precision restriction flow controller and shut-off valve for silicone tubing used in bioprocessing and pharmaceutical manufacturing applications. The threaded pitch can be calibrated to 2 mm per turn to minimize flow path turbulence. Available in 1/4" (6.4 mm) and 1" (12.7 mm), BioValve® is perfect for precise operation. The valves can be SIP repeatedly, and they can also be autoclaved at 134°C for 5 minutes.

Specifications:

Materials:

- Glass reinforced nylon 66
- USP Class VI certified

Sizes:

- 1/4" (6.4 mm) to 1" (12.7 mm) OD

Maximum Operating Pressure:

- 150 psig.

Maximum Cumulative Gamma Dose:

- 40 kiloGrays

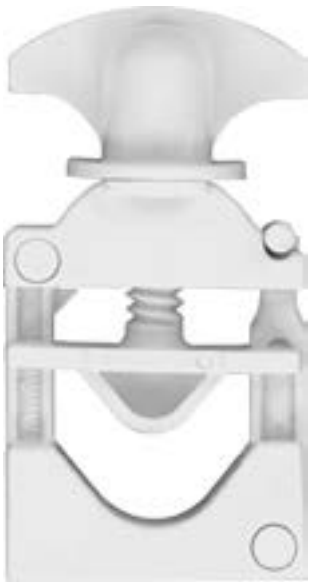

VBV0500NW

Pinch Valve, Mini, Glass Reinforced White Nylon,
1/4" (6.4 mm) to 1/2" (12.7 mm) Tubing OD



VBV1000NW

Pinch Valve, Maxi, Glass Reinforced White Nylon,
1/2" (12.7 mm) to 1" (25.4 mm) Tubing OD

SF Series

Sanitary Fittings

The SF Series sanitary fittings are based on design concepts calling for a heavy-duty part with superior side load strength, while providing superior flow-through characteristics, making them the connectors of choice for single-use bioprocesses. Pharmaceutical professionals find these plastic fittings offer all the benefits of disposable parts while offering performance capabilities not found in earlier versions of flanged fittings.



SFMN630 (-6005)
Sanitary Fitting, Mini Flange 3/4" to 600 Series Barb, 1/8" (3.2 mm) Tubing ID



SFMN655 (-6005 -J1A)
Sanitary Fitting, Mini Flange 3/4" to 600 Series Barb, 1/4" (6.4 mm) Tubing ID



SFMN670 (-6005 -J1A)
Sanitary Fitting, Mini Flange 3/4" to 600 Series Barb, 3/8" (9.5 mm) Tubing ID



SFMN680 (-6005 -J1A)
Sanitary Fitting, Mini Flange 3/4" to 600 Series Barb, 1/2" (12.7 mm) Tubing ID



SFMN6100 (-6005 -J1A)
Sanitary Fitting, Mini Flange 3/4" to 600 Series Barb, 3/4" (19.0 mm) Tubing ID



SFMNC (-6005 -J1A)
Sanitary Fitting, Mini Cap 3/4"

Features & Benefits:

- Animal-free materials
 - No BSE documentation required
- Radiused flow surfaces
 - Smooth uninterrupted flow
- Mini & Maxi sizes
 - Easy to retrofit current operations & works with commercially available biopharm clamps
- No particulate build-up
 - Interior surface controlled to 15 Ra microinch
- Reducer sizes available

Specifications:

Materials:

- Animal-Free Polypropylene, Natural PVDF

Tubing ID Sizes:

- 1/8", 1/4", 3/8", 1/2", 3/4", 1"
- Reducers 1" x 3/4", 1-1/2" x 3/4", 1-1/2" x 1", 2" x 3/4", 2" x 1-1/2"

Leak Resistance:

- Tested at 80 psi air under water for 90 seconds

Tubing Removal Force:

- 1/4" PP with C-Flex® shore A tubing: 21 lbs.
- 1/2" PP with C-Flex® shore A tubing: 89 lbs.
- 1" PP with C-Flex® shore A tubing: 121 lbs.



SFMX655 (-6005 -J1A)

Sanitary Fitting, Maxi Flange 1-1/2" to 600 Series Barb, 1/4" (6.4 mm) Tubing ID



SFMX670 (-6005 -J1A)

Sanitary Fitting, Maxi Flange 1-1/2" to 600 Series Barb, 3/8" (9.5 mm) Tubing ID



SFMX680 (-6005 -J1A)

Sanitary Fitting, Maxi Flange 1-1/2" to 600 Series Barb, 1/2" (12.7 mm) Tubing ID



SFMX6100 (-6005 -J1A)

Sanitary Fitting, Maxi Flange 1-1/2" to 600 Series Barb, 3/4" (19.0 mm) Tubing ID



SFMX6110 (-6005 -J1A)

Sanitary Fitting, Maxi Flange 1-1/2" to 600 Series Barb, 1" (25.4 mm) Tubing ID



SFMXC (-6005 -J1A)

Sanitary Fitting, Maxi Cap 1-1/2"

SF Series

Sanitary Fittings

The SF Series sanitary fittings are based on design concepts calling for a heavy-duty part with superior side load strength, while providing superior flow-through characteristics, making them the connectors of choice for single-use bioprocesses. Pharmaceutical professionals find these plastic fittings offer all the benefits of disposable parts while offering performance capabilities not found in earlier versions of flanged fittings.



SFM100/SFM075 (-6005 -J1A)
Sanitary Fitting, Concentric Reducer,
1" (25.4 mm) Landish TC x .75"
(19.0 mm) TC



SFM150/SFM075 (-6005 -J1A)
Sanitary Fitting, Concentric Reducer,
1.5" (38.1 mm) Landish TC x .75"
(19.0 mm) TC



SFM150/SFM100 (-6005 -J1A)
Sanitary Fitting, Concentric Reducer,
1.5" (38.1 mm) Landish TC x 1"
(25.4 mm) TC

Features & Benefits:

- Animal-free materials
 - No BSE documentation required
- Radiused flow surfaces
 - Smooth uninterrupted flow
- Mini & Maxi sizes
 - Easy to retrofit current operations & works with commercially available biopharm clamps
- No particulate build-up
 - Interior surface controlled to 15 Ra microinch
- Reducer sizes available

Specifications:

Materials:

- Animal-Free Polypropylene, Natural PVDF

Tubing ID Sizes:

- 1/4", 3/8", 1/2", 3/4", 1"
- Reducers 1" x 3/4", 1-1/2" x 3/4", 1-1/2" x 1", 2" x 3/4", 2" x 1-1/2"

Leak Resistance:

- Tested at 80 psi air under water for 90 seconds

Tubing Removal Force:

- 1/4" PP with C-Flex® shore A tubing: 21 lbs.
- 1/2" PP with C-Flex® shore A tubing: 89 lbs.
- 1" PP with C-Flex® shore A tubing: 121 lbs.



SFM200/SFM075 (-6005 -J1A)

Sanitary Fitting, Concentric Reducer, 2" (50.8 mm) Landish TC x .75" (19.0 mm) TC



SFM200/SFM150 (-6005 -J1A)

Sanitary Fitting, Concentric Reducer, 2" (50.8 mm) Landish TC x 1.5" (38.1 mm) TC

SF Series

Instrument Tees

SF Series Instrument Tees work well with existing pharmaceutical instrumentation and are available in 1/2" and 1" tubing IDs. Critical to a successful single-use implementation, the fittings work for instrument gauges, fluid transfer, and filtration applications. The configuration is a standard 1.5" TC style interface on the instrument side and tee style for the fluid path. The fittings also utilize Nordson MEDICAL's popular 600 series barb, which is ideally suited for silicone and TPE tubing. Constructed of Nordson MEDICAL's standard polyethylene resin, the instrument tees utilize materials found in many single-use bags being used around the world.

Features & Benefits:

- Works with existing pharmaceutical instrumentation
- Single-use technology
- ASME BPE compliant interface on the instrument side
- Tee style for the fluid path
- 600 series barb
- Common industry materials

Specifications:

Materials:

- Animal-Free Polyethylene

Tubing Sizes:

- 1/2" and 1" tubing IDs

Configuration:

- 1.5" TC style



SFMXt680 (-VP1)

Sanitary Fitting Instrument Tee, Maxi Flange to 600 Series Barb, 1/2" (12.7 mm) Tubing ID, Animal-free Natural Polyethylene



SFMXt6110 (-VP1)

Sanitary Fitting Instrument Tee, Maxi Flange to 600 Series Barb, 1" (25.4 mm) Tubing ID, Animal-free Natural Polyethylene

CYLINDRAFlow™

Manifolds

Nordson MEDICAL is proud to introduce the first all-in-one manifold for pharmaceutical and single-use biopharmaceutical fluid transfer applications. The revolutionary design of this patent-pending, compact fitting not only saves space, but also simplifies use and assembly. With five ports available in one component, gone are the many leak points found in traditional stopcock and Y connector manifolds. Ideal for downstream processing, multiple bags can easily be filled from one large bag. Flow is consistent as it travels around the inner body of the part, maintaining a steady pressure. The large flow selector is effortless to turn, and the lock-in-place feature gives you assurance that you are utilizing the desired port.

Features & Benefits:

- Can accommodate up to 5 fluid lines
- Flow restricted to one port at a time
- No pressure drop as fluid moves around & through the ports
- Intuitive push-to-turn flow selector
- Easier to use and fewer leak points than stopcock and Y connector manifolds
- Materials meet USP Class VI & ISO 10993 criteria
- Gamma radiation stable
- Can be daisy chained for additional ports
- Arrows to provide a clear indication of how to turn the flow selector and which port is in use
- Etched data code for easy access to product resources and material information

Specifications:

Materials:

- Body & flow selector - gamma stable polycarbonate
- Internal spring - 316 stainless steel
- Gasket - platinum-cured silicone

Operating Pressure:

- 15 psi (1.0 bar) liquid rated

Fits Tubing IDs:

- 3/8" (9.5 mm)

Barb Size:

- 600 series

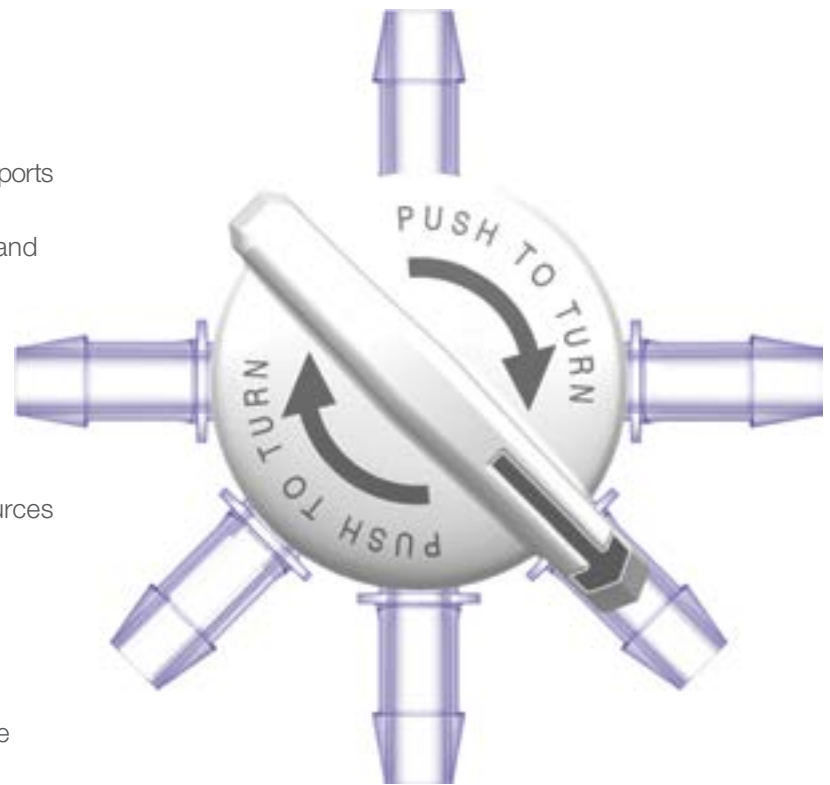

FMD5P670-001

CYLINDRAFlow™ Manifold Director, 600 Series Barbs, 3/8" (9.5 mm) Flow, 1 Input, 5 Outputs, 15 psi Liquid Rated, -9024 Polycarbonate Material

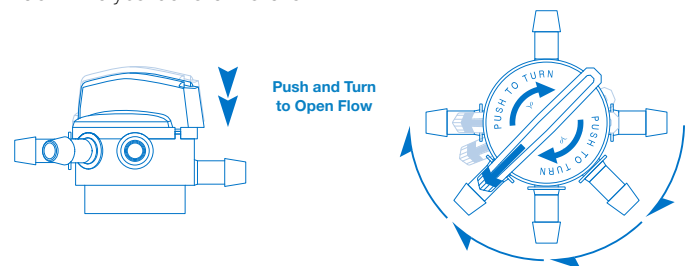

GASKETS

Nordson MEDICAL's gasket material options include Class VI compliant PTFE/EPDM and platinum-cured silicone in sizes that fit the 3/4" Mini Flange, 1-1/2" Maxi Flange, 2" Flange, and 3" Flange. Keeping customer requirements in mind, these components were manufactured for applications requiring the highest sanitary standards and chemical purity.

Tuf-flex® sanitary gaskets are unitized and will maintain ID without re-torquing or leaking.



GMX455 (-PX)
Molded Gasket for Maxi Flange SFMX Series Fittings



G40MPGR-TF150 (-E)
Molded Tuf-Flex® Gasket for Maxi Flange SFMX Series Fittings



GMN450 (-PX)
Molded Gasket for Mini Flange SFMN Series Fittings



G424TRX-0300
Molded Gasket for 3" Flange Fittings, Platinum-Cured Silicone

Features & Benefits:

- Class VI compliant materials
- 100% virgin raw materials & colorants
- Excellent wear performance
- Maintains seal integrity
- Complete material traceability

Specifications:

Materials:

- PTFE/EPDM
- Platinum-cured silicone

Gasket Sizes:

- 3/4" (19.0 mm) to 3" (76.2 mm)

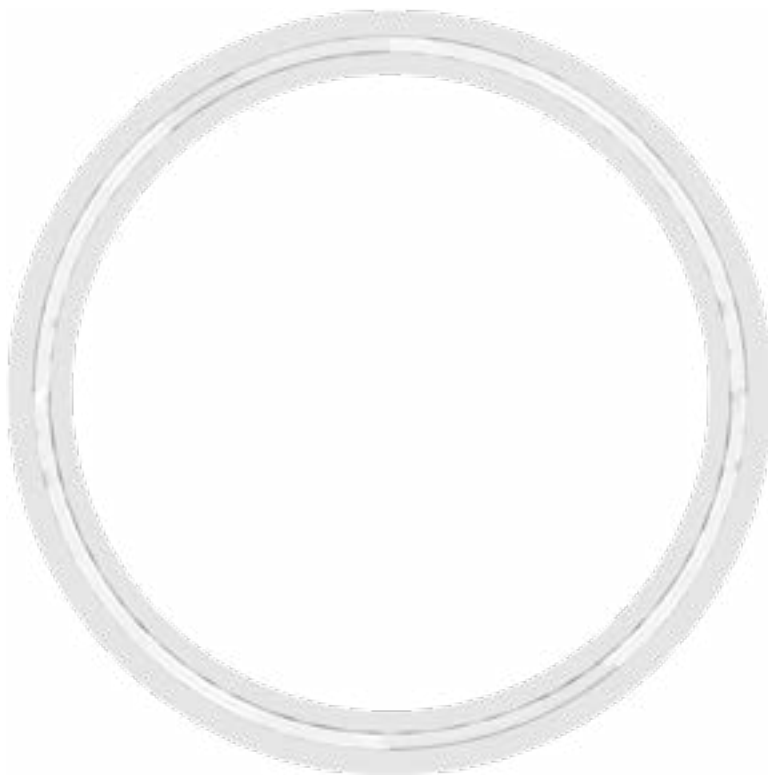

G40RX-PX-0400

Molded Gasket for 4" Flange Fittings, Platinum-Cured Silicone



GM4749TRX-0600

Molded Gasket for 6" Flange Fittings, Platinum-Cured Silicone

BAG

Ports

Nordson MEDICAL's high tech series of bag ports offers a variety of benefits to the biopharmaceutical industry. Value Pharma™ resin features animal derivative free qualification, USP Class VI certification, and the guarantee of heat sealing and conformance with polyethylene bags, and also provides a strong, 24-hour resistance to alcohol stress cracking. RENOLIT SOLMED Granuflex 4301 resin demonstrates lower leachable levels and high purity. The most notable of the bag ports' specifications are the parabolic lead and the alignment ribs. These two features, respectively, reduce the amount of time it takes to drain a bag by up to 24 percent and improve flow dynamics through the port.



SFBP630 (-VP1)

Bag Port with 600 Series Barb, Value Pharma™ Resin, 1/8" (3.2 mm) Tubing ID



SFBP655 (-VP1)

Bag Port with 600 Series Barb, Value Pharma™ Resin, 1/4" (6.4 mm) Tubing ID



SFBP670 (-VP1)

Bag Port with 600 Series Barb, Value Pharma™ Resin, 3/8" (9.5 mm) Tubing ID



SFBP680 (-VP1)

Bag Port with 600 Series Barb, Value Pharma™ Resin, 1/2" (12.7 mm) Tubing ID



SFBP6100 (-VP1)

Bag Port with 600 Series Barb, Value Pharma™ Resin, 3/4" (19.0 mm) Tubing ID



SFBP6110 (-VP1)

Bag Port with 600 Series Barb, Value Pharma™ Resin, 1" (25.4 mm) Tubing ID

Features & Benefits:

- Compliant to ASME BPE ferrule specifications
 - Works with leading industry single-use bags
- Parabolic lead
 - Reduces the time it takes to drain a bag by 17% to 24%
 - Similar results for both fluid and powder applications
- Alignment ribs
 - Improves fluid dynamics of flow through the port
- USP Class VI certification
- Resins ensure heat sealing with polyethylene bags

Specifications:

Materials:

- Value Pharma™ resin
 - Animal derivative free
 - Resistant to alcohol stress cracking
- RENOLIT SOLMED Granuflex 4301 resin
 - Animal derivative free
 - Demonstrates lower leachable levels & high purity

Barb Sizes:

- 1/8" (3.2 mm) to 1" (25.4 mm)

Sanitary TC Port Sizes:

- 1-1/2" (38.1 mm), 3" (76.2 mm), and 4" (101.6 mm)

Flow Rate:

- 8.37 gallons per minute



SFBPF1 (-VP1)

Bag Port with Ferrule Fitting
to 1-1/2" TC Connection



SFM3C-6005

Flat TC Style End Cap,
Animal Free Polypropylene,
3", Works with SFBPF3.



SFBPF3 (-VP1 -CM056)

Bag Port with Ferrule Fitting
to 3" TC Connection

SFBPF4 (-VP1)

Bag Port with Ferrule Fitting
to 4" TC Connection

SFM4C-6005

Flat End Cap, Animal
Free Polypropylene, 4"
(101.6 mm) Flange

OPPOSING

Barb Ports

Nordson MEDICAL offers the biomedical market opposing barb ports. The larger ports can be used in filling applications, and they are also ideally suited to work with sensors. Value Pharma™ resin features animal derivative free qualification, USP Class VI certification, and the guarantee of heat sealing and conformance with polyethylene bags. The resin also provides a strong, 24-hour resistance to alcohol stress cracking.



SFBP635/635 (-VP1)
Dip Tube (Opposable Barbs) with Two
600 Series Barbs, Value Pharma™
Resin, 3/16" (4.8 mm) Tubing ID



SFBP655/655 (-VP1)
Dip Tube (Opposable Barbs) with Two
600 Series Barbs, Value Pharma™
Resin, 1/4" (6.4 mm) Tubing ID



SFBP670/670 (-VP1)
Dip Tube (Opposable Barbs) with Two
600 Series Barbs, Value Pharma™
Resin, 3/8" (9.5 mm) Tubing ID

Features & Benefits:

- Easy to heat seal into film material
- Can be used in filling applications
- Works great with silicone & TPE style tubing
- Better tube retention
- 600 Series barb sizes
- Animal-free polyethylene
- Materials meet USP Class VI criteria

Specifications:

Materials:

- Value Pharma™ resin
 - Animal derivative free
 - Resistant to alcohol stress cracking

Tubing Sizes:

- 3/16" (4.8 mm) to 3/4" (19.0 mm)



SFBP680/680 (-VP1)

Dip Tube (Opposable Barbs) with Two 600 Series Barbs, Value Pharma™ Resin, 1/2" (12.7 mm) Tubing ID



SFBP6100/6100 (-VP1)

Dip Tube (Opposable Barbs) with Two 600 Series Barbs, Value Pharma™ Resin, 3/4" (19.0 mm) Tubing ID

TUBE

Fittings

Nordson MEDICAL offers barbed tubing fittings and tubing connectors in sizes ranging from 1/16" (1.6 mm) to 1" (25.4 mm) tubing ID in over 100 separate configurations in nylon, polypropylene, polycarbonate and PVDF, with other engineering resins available on special order. Available barbed fitting styles include straight tube connectors, elbow fittings, tee fittings, crosses, Y (wye) connectors, multi-port connectors, and multiple reducer combinations.

Several barb styles are offered to provide designers the widest range of assembly forces, pull-off resistance and blow-off resistance – without the need for clamps.

Straight Through Fittings



Reference Part Shown: **N035**

AA (-1 -6005 -J1A)

Straight Through Connector with Classic Series Barb, 1/16" (1.6 mm) Tubing ID

DD (-1 -2 -6005 -9)

Straight Through Connector with Classic Series Barb, 3/32" (2.4 mm) Tubing ID

CC (-1 -6005 -J1A)

Straight Through Connector with Classic Series Barb, 1/8" (3.2 mm) Tubing ID

N210 (-1 -2 -6005 -9 -J1A)

Straight Through Connector with 200 Series Barb, 1/16" (1.6 mm) Tubing ID

N220 (-1 -6005 -9)

Straight Through Connector with 200 Series Barb, 3/32" (2.4 mm) Tubing ID

N230 (-1 -2 -3 -5 -6005 -9 -J1A)

Straight Through Connector with 200 Series Barb, 1/8" (3.2 mm) Tubing ID

N410 (-1 -6005 -J1A)

Straight Through Connector with 400 Series Barb, 1/16" (1.6 mm) Tubing ID

N420 (-1 -6005 -J1A)

Straight Through Connector with 400 Series Barb, 3/32" (2.4 mm) Tubing ID

N430 (-1 -6005)

Straight Through Connector with 400 Series Barb, 1/8" (3.2 mm) Tubing ID

N004 (-6005 -9 -J1A)

Straight Through Connector with 500 Series Barb, 1/16" (1.6 mm) Tubing ID

N007 (-1 -2)

Straight Through Connector with 500 Series Barb, 3/32" (2.4 mm) Tubing ID

N013 (-1 -6005 -9 -J1A -9002)

Straight Through Connector with 500 Series Barb, 1/8" (3.2 mm) Tubing ID

Due to size, we are not able to display all large tube fittings. Please see www.nordsonmedical.com for part reference. Minimum package quantities vary by tube IDs. Please verify minimum package sizes when placing orders.

Straight Through Fittings



Reference Part Shown: N035

4040 (-1 -2 -6005 -J1A)

Straight Through Connector with Classic Series Barb, 5/32" (4.0 mm) Tubing ID

N440 (-6005 -J1A)

Straight Through Connector with 400 Series Barb, 5/32" (4.0 mm) Tubing ID

N025 (-1 -6005)

Straight Through Connector with 500 Series Barb, 5/32" (4.0 mm) Tubing ID

5050 (-1 -2 -6005 -9002)

Straight Through Connector with Classic Series Barb, 3/16" (4.8 mm) Tubing ID

N035 (-1 -6005)

Straight Through Connector with 500 Series Barb, 3/16" (4.8 mm) Tubing ID

6060 (-6005 -9 -J1A)

Straight Through Connector with Classic Series Barb, 1/4" (6.4 mm) Tubing ID

N055 (-2 -6005 -9)

Straight Through Connector with 500 Series Barb, 1/4" (6.4 mm) Tubing ID

N065 (-2 -6005 -J1A)

Straight Through Connector with 500 Series Barb, 5/16" (8.0 mm) Tubing ID

Custom Assembly

We produce standard components to fit your current assemblies and devices, but we also provide custom solutions by applying a variety of assembly options, such as joining fittings, connectors, filters, and other components to tubing. From systems using a single fitting to complex configurations utilizing various components, we can design complete assemblies to your requirements.

TUBE

Fittings

Nordson MEDICAL offers barbed tubing fittings and tubing connectors in sizes ranging from 1/16" (1.6 mm) to 1" (25.4 mm) tubing ID in over 100 separate configurations in nylon, polypropylene, polycarbonate and PVDF, with other engineering resins available on special order. Available barbed fitting styles include straight tube connectors, elbow fittings, tee fittings, crosses, Y (wye) connectors, multi-port connectors, and multiple reducer combinations.

Several barb styles are offered to provide designers the widest range of assembly forces, pull-off resistance and blow-off resistance – without the need for clamps.

Large Straight Through Fittings



Reference Part Shown: N670

N070 (-6005 -9)

Straight Through Connector with 500 Series Barb, 3/8" (9.5 mm) Tubing ID

N090 (-0)

Straight Through Connector with 500 Series Barb, 5/8" (16.0 mm) Tubing ID

N6100 (-6005)

Straight Through Connector with 600 Series Barb, 3/4" (19.0 mm) Tubing ID

N670 (-6005 -9 -J1A)

Straight Through Connector with 600 Series Barb, 3/8" (9.5 mm) Tubing ID

N690 (-0 -6005)

Straight Through Connector with 600 Series Barb, 5/8" (16.0 mm) Tubing ID

N110 (-0)

Straight Through Connector with 500 Series Barb, 1" (25.4 mm) Tubing ID

N080 (-6005)

Straight Through Connector with 500 Series Barb, 1/2" (12.7 mm) Tubing ID

N100 (-6005)

Straight Through Connector with 500 Series Barb, 3/4" (19.0 mm) Tubing ID

N6110 (-6005)

Straight Through Connector with 600 Series Barb, 1" (25.4 mm) Tubing ID

N680 (-6005 -J1A)

Straight Through Connector with 600 Series Barb, 1/2" (12.7 mm) Tubing ID

Due to size, we are not able to display all large tube fittings. Please see www.nordsonmedical.com for part reference. Minimum package quantities vary by tube IDs. Please verify minimum package sizes when placing orders.

Straight Through Reducer Fittings



Reference Part Shown: N035/013

AD (-1 -6005 -J1A)

Straight Through Reduction Connector with Classic Series Barb, 3/32" (2.4 mm) and 1/16" (1.6 mm) Tubing ID

N220/210 (-1 -6005)

Straight Through Reduction Connector with 200 Series Barb, 3/32" (2.4 mm) and 1/16" (1.6 mm) Tubing ID

N420/410 (-1 -2 -6005 -10 -J1A)

Straight Through Reduction Connector with 400 Series Barb, 3/32" (2.4 mm) and 1/16" (1.6 mm) Tubing ID

N007/004 (-6005)

Straight Through Reduction Connector with 500 Series Barb, 3/32" (2.4 mm) and 1/16" (1.6 mm) Tubing ID

AC (-0 -1 -2 -6005 -J1A)

Straight Through Reduction Connector with Classic Series Barb, 1/8" (3.2 mm) and 1/16" (1.6 mm) Tubing ID

N230/210 (-1 -6005 -9)

Straight Through Reduction Connector with 200 Series Barb, 1/8" (3.2 mm) and 1/16" (1.6 mm) Tubing ID

N430/410 (-1 -6005)

Straight Through Reduction Connector with 400 Series Barb, 1/8" (3.2 mm) and 1/16" (1.6 mm) Tubing ID

N013/004 (-1 -2 -6005 -9)

Straight Through Reduction Connector with 500 Series Barb, 1/8" (3.2 mm) and 1/16" (1.6 mm) Tubing ID

DC (-1 -6005 -9)

Straight Through Reduction Connector with Classic Series Barb, 1/8" (3.2 mm) and 3/32" (2.4 mm) Tubing ID

N230/220 (-1 -6005 -07 -9 -J1A)

Straight Through Reduction Connector with 200 Series Barb, 1/8" (3.2 mm) and 3/32" (2.4 mm) Tubing ID

N430/420 (-1 -2 -6005 -6012)

Straight Through Reduction Connector with 400 Series Barb, 1/8" (3.2 mm) and 3/32" (2.4 mm) Tubing ID

N013/007 (-1 -2 -6005 -6012 -9002)

Straight Through Reduction Connector with 500 Series Barb, 1/8" (3.2 mm) and 3/32" (2.4 mm) Tubing ID

TUBE

Fittings

Nordson MEDICAL offers barbed tubing fittings and tubing connectors in sizes ranging from 1/16" (1.6 mm) to 1" (25.4 mm) tubing ID in over 100 separate configurations in nylon, polypropylene, polycarbonate and PVDF, with other engineering resins available on special order. Available barbed fitting styles include straight tube connectors, elbow fittings, tee fittings, crosses, Y (wye) connectors, multi-port connectors, and multiple reducer combinations.

Several barb styles are offered to provide designers the widest range of assembly forces, pull-off resistance and blow-off resistance – without the need for clamps.

Straight Through Reducer Fittings



Reference Part Shown: N035/013

1040 (-1 -6005 -9)

Straight Through Reduction Connector with Classic Series Barb, 5/32" (4.0 mm) and 1/16" (1.6 mm) Tubing ID

N025/004 (-1 -2)

Straight Through Reduction Connector with 500 Series Barb, 5/32" (4.0 mm) and 1/16" (1.6 mm) Tubing ID

2040 (-1 -6005 -9)

Straight Through Reduction Connector with Classic Series Barb, 5/32" (4.0 mm) and 3/32" (2.4 mm) Tubing ID

N025/007 (-9)

Straight Through Reduction Connector with 500 Series Barb, 5/32" (4.0 mm) and 3/32" (2.4 mm) Tubing ID

3040 (-1 -2 -6005 -9 -J1A)

Straight Through Reduction Connector with Classic Series Barb, 5/32" (4.0 mm) and 1/8" (3.2 mm) Tubing ID

N025/013 (-1 -6005 -9 -J1A)

Straight Through Reduction Connector with 500 Series Barb, 5/32" (4.0 mm) and 1/8" (3.2 mm) Tubing ID

1050 (-1 -6005 -9)

Straight Through Reduction Connector with Classic Series Barb, 3/16" (4.8 mm) and 1/16" (1.6 mm) Tubing ID

2050 (-1 -6005 -9)

Straight Through Reduction Connector with Classic Series Barb, 3/16" (4.8 mm) and 3/32" (2.4 mm) Tubing ID

N035/007 (-2 -6005 -9)

Straight Through Reduction Connector with 500 Series Barb, 3/16" (4.8 mm) and 3/32" (2.4 mm) Tubing ID

3050 (-1 -6005 -81 -9 -J1A)

Straight Through Reduction Connector with Classic Series Barb, 3/16" (4.8 mm) and 1/8" (3.2 mm) Tubing ID

N035/013 (-1 -6005 -81 -J1A)

Straight Through Reduction Connector with 500 Series Barb, 3/16" (4.8 mm) and 1/8" (3.2 mm) Tubing ID

4050 (-2 -6005 -9 -J1A)

Straight Through Reduction Connector with Classic Series Barb, 3/16" (4.8 mm) and 5/32" (4.0 mm) Tubing ID

Due to size, we are not able to display all large tube fittings. Please see www.nordsonmedical.com for part reference. Minimum package quantities vary by tube IDs. Please verify minimum package sizes when placing orders.

Straight Through Reducer Fittings



Reference Part Shown: N035/013

N035/025 (-2 -6005 -9)

Straight Through Reduction Connector with 500 Series Barb, 3/16" (4.8 mm) and 5/32" (4.0 mm) Tubing ID

3060 (-1 -6005 -9 -J1A -J1A2)

Straight Through Reduction Connector with Classic Series Barb, 1/4" (6.4 mm) and 1/8" (3.2 mm) Tubing ID

N055/013 (-6005 -J1A)

Straight Through Reduction Connector with 500 Series Barb, 1/4" (6.4 mm) and 1/8" (3.2 mm) Tubing ID

4060 (-1 -6005 -J1A)

Straight Through Reduction Connector with Classic Series Barb, 1/4" (6.4 mm) and 5/32" (4.0 mm) Tubing ID

N055/025 (-1 -2 -6005)

Straight Through Reduction Connector with 500 Series Barb, 1/4" (6.4 mm) and 5/32" (4.0 mm) Tubing ID

5060 (-1 -6005 -9 -9002 -J1A)

Straight Through Reduction Connector with Classic Series Barb, 1/4" (6.4 mm) and 3/16" (4.8 mm) Tubing ID

N055/035 (-2 -6005)

Straight Through Reduction Connector with 500 Series Barb, 1/4" (6.4 mm) and 3/16" (4.8 mm) Tubing ID

N065/025 (-6005)

Straight Through Reduction Connector with 500 Series Barb, 5/16" (8.0 mm) and 5/32" (4.0 mm) Tubing ID

N065/035 (-6005)

Straight Through Reduction Connector with 500 Series Barb, 5/16" (8.0 mm) and 3/16" (4.8 mm) Tubing ID

N065/055 (-1 -6005)

Straight Through Reduction Connector with 500 Series Barb, 5/16" (8.0 mm) and 1/4" (6.4 mm) Tubing ID

TUBE

Fittings

Nordson MEDICAL offers barbed tubing fittings and tubing connectors in sizes ranging from 1/16" (1.6 mm) to 1" (25.4 mm) tubing ID in over 100 separate configurations in nylon, polypropylene, polycarbonate and PVDF, with other engineering resins available on special order. Available barbed fitting styles include straight tube connectors, elbow fittings, tee fittings, crosses, Y (wye) connectors, multi-port connectors, and multiple reducer combinations.

Several barb styles are offered to provide designers the widest range of assembly forces, pull-off resistance and blow-off resistance – without the need for clamps.

Large Straight Through Reducer Fittings



Reference Part Shown: N070/13

N070/013 (-6005 -9 -J1A)

Straight Through Reduction Connector with 500 Series Barb, 3/8" (9.5 mm) and 1/8" (3.2 mm) Tubing ID

N670/630 (-6005)

Straight Through Reduction Connector with 600 Series Barb, 3/8" (9.5 mm) and 1/8" (3.2 mm) Tubing ID

N070/055 (-0 -6005 -9)

Straight Through Reduction Connector with 500 Series Barb, 3/8" (9.5 mm) and 1/4" (6.4 mm) Tubing ID

N670/655 (-6005 -9)

Straight Through Reduction Connector with 600 Series Barb, 3/8" (9.5 mm) and 1/4" (6.4 mm) Tubing ID

N080/055 (-0 -6005)

Straight Through Reduction Connector with 500 Series Barb, 1/2" (12.7 mm) and 1/4" (6.4 mm) Tubing ID

N680/655 (-6005 -J1A)

Straight Through Reduction Connector with 600 Series Barb, 1/2" (12.7 mm) and 1/4" (6.4 mm) Tubing ID

N080/070 (-0 -6005)

Straight Through Reduction Connector with 500 Series Barb, 1/2" (12.7 mm) and 3/8" (9.5 mm) Tubing ID

N680/670 (-6005 -9)

Straight Through Reduction Connector with 600 Series Barb, 1/2" (12.7 mm) and 3/8" (9.5 mm) Tubing ID

N090/055 (-0)

Straight Through Reduction Connector with 500 Series Barb, 5/8" (16.0 mm) and 1/4" (6.4 mm) Tubing ID

N690/655 (-6005)

Straight Through Reduction Connector with 600 Series Barb, 5/8" (16.0 mm) and 1/4" (6.4 mm) Tubing ID

N090/070 (-0)

Straight Through Reduction Connector with 500 Series Barb, 5/8" (16.0 mm) and 3/8" (9.5 mm) Tubing ID

N690/670 (-6005)

Straight Through Reduction Connector with 600 Series Barb, 5/8" (16.0 mm) and 3/8" (9.5 mm) Tubing ID

Due to size, we are not able to display all large tube fittings. Please see www.nordsonmedical.com for part reference. Minimum package quantities vary by tube IDs. Please verify minimum package sizes when placing orders.

Large Straight Through Reducer Fittings



Reference Part Shown: N070/13

N6100/670 (-6005)

Straight Through Reduction Connector with 600 Series Barb, 3/4" (19 mm) and 3/8" (9.5 mm) Tubing ID

N100/080 (-0 -6005)

Straight Through Reduction Connector with 500 Series Barb, 3/4" (19.0 mm) and 1/2" (12.7 mm) Tubing ID

N6100/680 (-6005)

Straight Through Reduction Connector with 600 Series Barb, 3/4" (19.0 mm) and 1/2" (12.7 mm) Tubing ID

N6110/680 (-6005)

Straight Through Reduction Connector with 600 Series Barb, 1" (25.4 mm) and 1/2" (12.7 mm) Tubing ID

N110/100 (-0 -6005)

Straight Through Reduction Connector with 500 Series Barb, 1" (25.4 mm) and 3/4" (19.0 mm) Tubing ID

N6110/6100 (-6005)

Straight Through Reduction Connector with 600 Series Barb, 1" (25.4 mm) and 3/4" (19.0 mm) Tubing ID

Looking for Something Different?

Most of our best product ideas have come from you, our customers. While we pride ourselves on our extensive product offering, we recognize that your needs are ever-changing and that our products, too, must adapt to your needs.

If there's a new product you think Nordson MEDICAL should make, please send us an email at designcenter@nordsonmedical.com describing your product concept in as much detail as you desire. We will contact you with any questions, and who knows - the next catalog edition could include products YOU told us to build.

TUBE

Fittings

Nordson MEDICAL offers barbed tubing fittings and tubing connectors in sizes ranging from 1/16" (1.6 mm) to 1" (25.4 mm) tubing ID in over 100 separate configurations in nylon, polypropylene, polycarbonate and PVDF, with other engineering resins available on special order. Available barbed fitting styles include straight tube connectors, elbow fittings, tee fittings, crosses, Y (wye) connectors, multi-port connectors, and multiple reducer combinations.

Several barb styles are offered to provide designers the widest range of assembly forces, pull-off resistance and blow-off resistance – without the need for clamps.

Elbow Fittings



Reference Part
Shown: **L230**

Need Samples for Evaluation?

You can call to request most of our standard product in quantities of 5, or less, for free application evaluation.

+1 (970) 267-5200
Toll Free: (888) 404-5837

L10 (-1 -2 -6005 -J1A)

Elbow Connector with Classic Series Barb, 1/16" (1.6 mm) Tubing ID

L210 (-1 -2 -6005 -J1A)

Elbow Connector with 200 Series Barb, 1/16" (1.6 mm) Tubing ID

L410 (-1 -6005)

Elbow Connector with 400 Series Barb, 1/16" (1.6 mm) Tubing ID

L20 (-1 -6005 -J1A)

Elbow Connector with Classic Series Barb, 3/32" (2.4 mm) Tubing ID

L220 (-1 -6005 -6012 -9002)

Elbow Connector with 200 Series Barb, 3/32" (2.4 mm) Tubing ID

L420 (-1 -6005 -J1A)

Elbow Connector with 400 Series Barb, 3/32" (2.4 mm) Tubing ID

L30 (-1 -2 -6005)

Elbow Connector with Classic Series Barb, 1/8" (3.2 mm) Tubing ID

L230 (-1 -2 -6005 -9 -J1A)

Elbow Connector with 200 Series Barb, 1/8" (3.2 mm) Tubing ID

L430 (-1 -2 -6005)

Elbow Connector with 400 Series Barb, 1/8" (3.2 mm) Tubing ID

L40 (-1 -6005 -J1A)

Elbow Connector with Classic Series Barb, 5/32" (4.0 mm) Tubing ID

L440 (-2)

Elbow Connector with 400 Series Barb, 5/32" (4.0 mm) Tubing ID

L50 (-1 -2 -6005)

Elbow Connector with Classic Series Barb, 3/16" (4.8 mm) Tubing ID

L60 (-1 -6005 -J1A)

Elbow Connector with Classic Series Barb, 1/4" (6.4 mm) Tubing ID

Due to size, we are not able to display all large tube fittings. Please see www.nordsonmedical.com for part reference. Minimum package quantities vary by tube IDs. Please verify minimum package sizes when placing orders.

Large Elbow Fittings

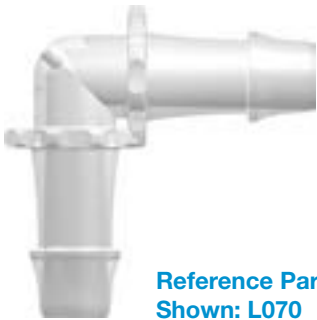

Reference Part
Shown: L070

L070 (-6005)

Elbow Connector with 500 Series Barb,
3/8" (9.5 mm) Tubing ID

L080 (-0 -6005)

Elbow Connector with 500 Series Barb,
1/2" (12.7 mm) Tubing ID

L090 (-0)

Elbow Connector with 500 Series Barb,
5/8" (16.0 mm) Tubing ID

L100 (-0 -6005)

Elbow Connector with 500 Series Barb,
3/4" (19.0 mm) Tubing ID

L110 (-0 -6005)

Elbow Connector with 500 Series Barb,
1" (25.4 mm) Tubing ID

L6110 (-6005)

Elbow Connector with 600 Series Barb,
1" (25.4 mm) Tubing ID

CF494 (-6005)

Low-Profile Elbow Connector with
Custom 600 Series Barb, 1" (25.4 mm)
Tubing ID

Need More Details?

Part drawings, minimum order quantities,
and CAD requests can be found online at
www.nordsonmedical.com.

TUBE

Fittings

Nordson MEDICAL offers barbed tubing fittings and tubing connectors in sizes ranging from 1/16" (1.6 mm) to 1" (25.4 mm) tubing ID in over 100 separate configurations in nylon, polypropylene, polycarbonate and PVDF, with other engineering resins available on special order. Available barbed fitting styles include straight tube connectors, elbow fittings, tee fittings, crosses, Y (wye) connectors, multi-port connectors, and multiple reducer combinations.

Several barb styles are offered to provide designers the widest range of assembly forces, pull-off resistance and blow-off resistance – without the need for clamps.

Elbow Reducer Fittings



**Reference Part
Shown: L230/220**

L220/210 (-1 -6005 -9 -J1A)

Elbow Reduction Connector with 200 Series Barb, 3/32" (2.4 mm) and 1/16" (1.6 mm) Tubing ID

L420/410 (-2 -J1A)

Elbow Reduction Connector with 400 Series Barb, 3/32" (2.4 mm) and 1/16" (1.6 mm) Tubing ID

L230/210 (-1 -2 -6005 -J1A)

Elbow Reduction Connector with 200 Series Barb, 1/8" (3.2 mm) and 1/16" (1.6 mm) Tubing ID

L230/220 (-1 -2 -6005 -9 -J1A)

Elbow Reduction Connector with 200 Series Barb, 1/8" (3.2 mm) and 3/32" (2.4 mm) Tubing ID

L430/420 (-1 -2 -J1A)

Elbow Reduction Connector with 400 Series Barb, 1/8" (3.2 mm) and 3/32" (2.4 mm) Tubing ID

Large Elbow Reducer Fittings



**Reference Part
Shown: L070/055**

L070/055 (-0 -6005)

Elbow Reduction Connector with 500 Series Barb, 3/8" (9.5 mm) and 1/4" (6.4 mm) Tubing ID

L080/070 (-0)

Elbow Reduction Connector with 500 Series Barb, 1/2" (12.7 mm) and 3/8" (9.5 mm) Tubing ID

L100/080 (-0)

Elbow Reduction Connector with 500 Series Barb, 3/4" (19.0 mm) and 1/2" (12.7 mm) Tubing ID

L110/100 (-0)

Elbow Reduction Connector with 500 Series Barb, 1" (25.4 mm) and 3/4" (19.0 mm) Tubing ID

Due to size, we are not able to display all large tube fittings. Please see www.nordsonmedical.com for part reference. Minimum package quantities vary by tube IDs. Please verify minimum package sizes when placing orders.

Tee Fittings



Reference Part Shown: T230

T10 (-1 -6005 -J1A)

Tee Connector with Classic Series Barb,
1/16" (1.6 mm) Tubing ID

T210 (-1 -2 -6005 -9 -J1A)

Tee Connector with 200 Series Barb,
1/16" (1.6 mm) Tubing ID

T410 (-1 -6005)

Tee Connector with 400 Series Barb,
1/16" (1.6 mm) Tubing ID

T20 (-1 -6005 -J1A)

Tee Connector with Classic Series Barb,
3/32" (2.4 mm) Tubing ID

T220 (-1 -2 -6005 -6012 -J1A)

Tee Connector with 200 Series Barb,
3/32" (2.4 mm) Tubing ID

T420 (-1 -6005 -J1A)

Tee Connector with 400 Series Barb,
3/32" (2.4 mm) Tubing ID

T30 (-1 -2 -6005 -9 -J1A)

Tee Connector with Classic Series Barb,
1/8" (3.2 mm) Tubing ID

T230 (-1 -2 -5 -6005 -9 -J1A)

Tee Connector with 200 Series Barb,
1/8" (3.2 mm) Tubing ID

T430 (-1 -6005 -9002 -J1A)

Tee Connector with 400 Series Barb,
1/8" (3.2 mm) Tubing ID

T013 (-6005)

Tee Connector with 500 Series Barb,
1/8" (3.2 mm) Tubing ID

T40 (-1 -6005 -J1A)

Tee Connector with Classic Series Barb,
5/32" (4.0 mm) Tubing ID

T250 (-1 -2 -6005 -J1A)

Tee Connector with 200 Series Barb,
3/16" (4.8 mm) Tubing ID

T60 (-1 -2 -6005 -J1A)

Tee Connector with Classic Series Barb,
1/4" (6.4 mm) Tubing ID

T055 (-6005)

Tee Connector with 500 Series Barb,
1/4" (6.4 mm) Tubing ID

TUBE

Fittings

Nordson MEDICAL offers barbed tubing fittings and tubing connectors in sizes ranging from 1/16" (1.6 mm) to 1" (25.4 mm) tubing ID in over 100 separate configurations in nylon, polypropylene, polycarbonate and PVDF, with other engineering resins available on special order. Available barbed fitting styles include straight tube connectors, elbow fittings, tee fittings, crosses, Y (wye) connectors, multi-port connectors, and multiple reducer combinations.

Several barb styles are offered to provide designers the widest range of assembly forces, pull-off resistance and blow-off resistance – without the need for clamps.

Large Tee Fittings



Reference Part Shown: **T070**

T070 (-6005 -9)

Tee Connector with 500 Series Barb,
3/8" (9.5 mm) Tubing ID

T670 (-1 -6005)

Tee Connector with 600 Series Barb,
3/8" (9.5 mm) Tubing ID

T080 (-0 -6005)

Tee Connector with 500 Series Barb,
1/2" (12.7 mm) Tubing ID

T680 (-6005 -J1A)

Tee Connector with 600 Series Barb,
1/2" (12.7 mm) Tubing ID

T690 (-6005)

Tee Connector with 600 Series Barb,
5/8" (16.0 mm) Tubing ID

T100 (-6005)

Tee Connector with 500 Series Barb,
3/4" (19.0 mm) Tubing ID

T6100 (-6005)

Tee Connector with 600 Series Barb,
3/4" (19.0 mm) Tubing ID

T110 (-0)

Tee Connector with 500 Series Barb,
1" (25.4 mm) Tubing ID

T6110 (-6005)

Tee Connector with 600 Series Barb,
1" (25.4 mm) Tubing ID

Due to size, we are not able to display all large tube fittings. Please see www.nordsonmedical.com for part reference. Minimum package quantities vary by tube IDs. Please verify minimum package sizes when placing orders.

Tee Reducer Fittings



Reference Part Shown: T360/230

T410/420 (-2 -6005)

Tee Reduction Connector with 400 Series Barb, 1/16" (1.6 mm) and 3/32" (2.4 mm) Tubing ID

T210/230 (-1 -6005 -9)

Tee Reduction Connector with 200 Series Barb, 1/16" (1.6 mm) and 1/8" (3.2 mm) Tubing ID

T410/430 (-2 -6005)

Tee Reduction Connector with 400 Series Barb, 1/16" (1.6 mm) and 1/8" (3.2 mm) Tubing ID

T220/210 (-1 -2 -6005 -9 -J1A)

Tee Reduction Connector with 200 Series Barb, 3/32" (2.4 mm) and 1/16" (1.6 mm) Tubing ID

T220R210 (-2 -9 -J1A)

Tee Reduction Connector with 200 Series Barb, 3/32" (2.4 mm) and 1/16" (1.6 mm) Tubing ID

T420/410 (-2)

Tee Reduction Connector with 400 Series Barb, 3/32" (2.4 mm) and 1/16" (1.6 mm) Tubing ID

T420R410 (-1 -2 -J1A)

Tee Reduction Connector with 400 Series Barb, 3/32" (2.4 mm) and 1/16" (1.6 mm) Tubing ID

T210/220 (-1 -6005 -9)

Tee Reduction Connector with 200 Series Barb, 3/32" (2.4 mm) and 1/16" (1.6 mm) Tubing ID

T220/230 (-1 -6005 -9)

Tee Reduction Connector with 200 Series Barb, 3/32" (2.4 mm) and 1/8" (3.2 mm) Tubing ID

T420/430 (-1)

Tee Reduction Connector with 400 Series Barb, 3/32" (2.4 mm) and 1/8" (3.2 mm) Tubing ID

T230/210 (-1 -2 -6005 -J1A)

Tee Reduction Connector with 200 Series Barb, 1/8" (3.2 mm) and 1/16" (1.6 mm) Tubing ID

T230R210 (-1 -9)

Tee Reduction Connector with 200 Series Barb, 1/8" (3.2 mm) and 1/16" (1.6 mm) Tubing ID

TUBE

Fittings

Nordson MEDICAL offers barbed tubing fittings and tubing connectors in sizes ranging from 1/16" (1.6 mm) to 1" (25.4 mm) tubing ID in over 100 separate configurations in nylon, polypropylene, polycarbonate and PVDF, with other engineering resins available on special order. Available barbed fitting styles include straight tube connectors, elbow fittings, tee fittings, crosses, Y (wye) connectors, multi-port connectors, and multiple reducer combinations.

Several barb styles are offered to provide designers the widest range of assembly forces, pull-off resistance and blow-off resistance – without the need for clamps.

Tee Reducer Fittings



Reference Part Shown: T360/230

T430/410 (-2 -J1A)

Tee Reduction Connector with 400 Series Barb, 1/8" (3.2 mm) and 1/16" (1.6 mm) Tubing ID

T430R410 (-1 -2 -6005 -J1A)

Tee Reduction Connector with 400 Series Barb, 1/8" (3.2 mm) and 1/16" (1.6 mm) Tubing ID

T230/220 (-1 -2 -6005 -9 -J1A)

Tee Reduction Connector with 200 Series Barb, 1/8" (3.2 mm) and 3/32" (2.4 mm) Tubing ID

T230R220 (-6005 -9 -J1A)

Tee Reduction Connector with 200 Series Barb, 1/8" (3.2 mm) and 3/32" (2.4 mm) Tubing ID

T430/420 (-1 -2 -3 -J1A)

Tee Reduction Connector with 400 Series Barb, 1/8" (3.2 mm) and 3/32" (2.4 mm) Tubing ID

T430R420 (-2 -J1A)

Tee Reduction Connector with 400 Series Barb, 1/8" (3.2 mm) and 3/32" (2.4 mm) Tubing ID

T360/220 (-2 -6005 -9)

Tee Reduction Connector with 200 and 300 Series Barb, 1/4" (6.4 mm) and 3/32" (2.4 mm) Tubing ID

T360/230 (-1 -6005 -9)

Tee Reduction Connector with 200 and 300 Series Barb, 1/4" (6.4 mm) and 1/8" (3.2 mm) Tubing ID

T360/250 (-1 -2 -9)

Tee Reduction Connector with 200 and 300 Series Barb, 1/4" (6.4 mm) and 3/16" (4.8 mm) Tubing ID

Need More Details?

Part drawings, minimum order quantities, and CAD requests can be found online at www.nordsonmedical.com.

Due to size, we are not able to display all large tube fittings. Please see www.nordsonmedical.com for part reference. Minimum package quantities vary by tube IDs. Please verify minimum package sizes when placing orders.

Large Tee Reducer Fittings



Reference Part Shown: T070/055

T070/055 (-0 -6005 -9)

Tee Reduction Connector with 500 Series Barbs, 3/8" (9.5 mm) and 1/4" (6.4 mm) Tubing ID

T080/055 (-0 -6005)

Tee Reduction Connector with 500 Series Barb, 1/2" (12.7 mm) and 1/4" (6.4 mm) Tubing ID

T080/070 (-6005)

Tee Reduction Connector with 500 Series Barbs, 1/2" (12.7 mm) and 3/8" (9.5 mm) Tubing ID

T100/080 (-0 -6005 -9)

Tee Reduction Connector with 500 Series Barbs, 3/4" (19.0 mm) and 1/2" (12.7 mm) Tubing ID

T110/100 (-0 -6005)

Tee Reduction Connector with 500 Series Barb, 1" (25.4 mm) and 3/4" (19.0 mm) Tubing ID

T670/655 (-6005)

Tee Reduction Connector with 600 Series Barb, 3/8" x 2 (9.5 mm) and 1/4" (6.4 mm) Tubing ID

T680/655 (-6005)

Tee Reduction Connector with 600 Series Barb, 1/2" x 2 (12.7 mm) and 1/4" (6.4 mm) Tubing ID

T680/670 (-6005)

Tee Reduction Connector with 600 Series Barb, 1/2" x 2 (12.7 mm) and 3/8" (9.5 mm) Tubing ID

T6100/670 (-6005)

Tee Reduction Connector with 600 Series Barb, 3/4" x 2 (19.0 mm) and 3/8" (9.5 mm) Tubing ID

T6100/680 (-6005)

Tee Reduction Connector with 600 Series Barb, 3/4" x 2 (19.0 mm) and 1/2" (12.7 mm) Tubing ID

T6110/6100 (-6005)

Tee Reduction Connector with 600 Series Barb, 1" x 2 (25.4 mm) and 3/4" (19.0 mm) Tubing ID

TUBE

Fittings

Nordson MEDICAL offers barbed tubing fittings and tubing connectors in sizes ranging from 1/16" (1.6 mm) to 1" (25.4 mm) tubing ID in over 100 separate configurations in nylon, polypropylene, polycarbonate and PVDF, with other engineering resins available on special order. Available barbed fitting styles include straight tube connectors, elbow fittings, tee fittings, crosses, Y (wye) connectors, multi-port connectors, and multiple reducer combinations.

Several barb styles are offered to provide designers the widest range of assembly forces, pull-off resistance and blow-off resistance – without the need for clamps.

Y Fittings



Reference Part Shown: Y250

Y210 (-1 -2 -6005 -9 -J1A)

Y Connector with 200 Series Barb,
1/16" (1.6 mm) Tubing ID

Y240 (-1 -6005 -9 -J1A)

Y Connector with 200 Series Barb,
5/32" (4.0 mm) Tubing ID

Y410 (-6005)

Y Connector with 400 Series Barb,
1/16" (1.6 mm) Tubing ID

Y250 (-1 -6005 -9 -J1A)

Y Connector with 200 Series Barb,
3/16" (4.8 mm) Tubing ID

Y220 (-1 -2 -6005 -9 -J1A)

Y Connector with 200 Series Barb,
3/32" (2.4 mm) Tubing ID

Y450 (-1 -6005 -6012)

Y Connector with 400 Series Barb,
3/16" (4.8 mm) Tubing ID

Y420 (-1 -6005)

Y Connector with 400 Series Barb,
3/32" (2.4 mm) Tubing ID

Y260 (-1 -2 -6005 -9 -9002 -J1A)

Y Connector with 200 Series Barb,
1/4" (6.4 mm) Tubing ID

Y230 (-1 -2 -6005 -9 -9002 -9010 -J1A)

Y Connector with 200 Series Barb,
1/8" (3.2 mm) Tubing ID

Y460 (-1 -6005 -9 -J1A)

Y Connector with 400 Series Barb,
1/4" (6.4 mm) Tubing ID

Y430 (-1 -2 -6005)

Y Connector with 400 Series Barb,
1/8" (3.2 mm) Tubing ID

Y055 (-6005)

Y Connector with 500 Series Barb,
1/4" (6.4 mm) Tubing ID

Y013 (-6005)

Y Connector with 500 Series Barb,
1/8" (3.2 mm) Tubing ID

Due to size, we are not able to display all large tube fittings. Please see www.nordsonmedical.com for part reference. Minimum package quantities vary by tube IDs. Please verify minimum package sizes when placing orders.

Large Y Fittings



Reference Part Shown: Y070

Y070 (-6005)

Y Connector with 500 Series Barb, 3/8" (9.5 mm) Tubing ID

Y670 (-6005 -9 -J1A)

Y Connector with 600 Series Barb, 3/8" (9.5 mm) Tubing ID

Y080 (-0 -6005)

Y Connector with 500 Series Barb, 1/2" (12.7 mm) Tubing ID

Y680 (-6005 -J1A)

Y Connector with 600 Series Barb, 1/2" (12.7 mm) Tubing ID

Y690 (-6005)

Y Connector with 600 Series Barb, 5/8" (16.0 mm) Tubing ID

Y100 (-0 -6005 -J1A)

Y Connector with 500 Series Barb, 3/4" (19.0 mm) Tubing ID

Y6100 (-6005)

Y Connector with 600 Series Barb, 3/4" (19.0 mm) Tubing ID

Y110 (-6005)

Y Connector with 500 Series Barb, 1" (25.4 mm) Tubing ID

Y090 (-0 -6005 -J1A)

Y Connector with 500 Series Barb, 5/8" (16.0 mm) Tubing ID

Y6110 (-6005)

Y Connector with 600 Series Barb, 1" (25.4 mm) Tubing ID

Large Y Reducer Fittings



Reference Part Shown: Y630/655

Y630/655 (-6005)

Y Reduction Connector with 600 Series Barb, 1/8" x 2 (3.2 mm) and 1/4" (6.4 mm) Tubing ID

Y655/670 (-6005)

Y Reduction Connector with 600 Series Barb, 1/4" x 2 (6.4 mm) and 3/8" (9.5 mm) Tubing ID

Y670/680 (-6005)

Y Reduction Connector with 600 Series Barb, 3/8" x 2 (9.5 mm) and 1/2" (12.7 mm) Tubing ID

Y6100/6110 (-6005)

Y Reduction Connector with 600 Series Barb, 3/4" x 2 (19.0 mm) and 1" (25.4 mm) Tubing ID

TUBE

Fittings

Nordson MEDICAL offers barbed tubing fittings and tubing connectors in sizes ranging from 1/16" (1.6 mm) to 1" (25.4 mm) tubing ID in over 100 separate configurations in nylon, polypropylene, polycarbonate and PVDF, with other engineering resins available on special order. Available barbed fitting styles include straight tube connectors, elbow fittings, tee fittings, crosses, Y (wye) connectors, multi-port connectors, and multiple reducer combinations.

Several barb styles are offered to provide designers the widest range of assembly forces, pull-off resistance and blow-off resistance – without the need for clamps.

Multiport Fittings



Reference Part Shown: **4PX230**

3PF210 (-6005)

Three-Port F Style Manifold with 200 Series Barb, 1/16" (1.6 mm) Tubing ID

3PF220 (-6005)

Three-Port F Style Manifold with 200 Series Barb, 3/32" (2.4 mm) Tubing ID

3PF230 (-1 -6005)

Three-Port F Style Manifold with 200 Series Barb, 1/8" (3.2 mm) Tubing ID

4PX210 (-1 -6005)

Four-Port Cross Style Manifold with 200 Series Barb, 1/16" (1.6 mm) Tubing ID

4PX220 (-1 -6005)

Four-Port Cross Style Manifold with 200 Series Barb, 3/32" (2.4 mm) Tubing ID

4PX230 (-1 -6005)

Four-Port Cross Style Manifold with 200 Series Barb, 1/8" (3.2 mm) Tubing ID

4PDL220 (-1)

Four-Port Double Elbow Style Manifold with 200 Series Barb, 3/32" (2.4 mm) Tubing ID

4PLL210 (-6005)

Four-Port Thru Flow Double Elbow Style Manifold with 200 Series Barb, 1/16" (1.6 mm) Tubing ID

Need Samples for Evaluation?

You can call to request most of our standard product in quantities of 5, or less, for free application evaluation.

+1 (970) 267-5200

Toll Free: (888) 404-5837

Due to size, we are not able to display all large tube fittings. Please see www.nordsonmedical.com for part reference. Minimum package quantities vary by tube IDs. Please verify minimum package sizes when placing orders.

Multiport Fittings



Reference Part Shown: **4PX230**

4PLL220 (-1 -6005 -9)

Four-Port Thru Flow Double Elbow Style Manifold with 200 Series Barb, 3/32" (2.4 mm) Tubing ID

4PLL230 (-1 -2 -6005)

Four-Port Thru Flow Double Elbow Style Manifold with 200 Series Barb, 1/8" (3.2 mm) Tubing ID

6PDT220 (-6005)

Six-Port Double T Style Manifold with 200 Series Barb, 3/32" (2.4 mm) Tubing ID

6PDT230 (-1)

Six-Port Double T Style Manifold with 200 Series Barb, 1/8" (3.2 mm) Tubing ID

6PTT230 (-6005)

Six-Port Thru Flow Double T Style Manifold with 200 Series Barb, 1/8" (3.2 mm) Tubing ID

Need it Fast?

You can order any of our 5,000+ parts online now with no order \$ minimums, 24 hours a day, 7 days a week!
www.nordsonmedical.com

TUBE

Fittings

Nordson MEDICAL offers barbed tubing fittings and tubing connectors in sizes ranging from 1/16" (1.6 mm) to 1" (25.4 mm) tubing ID in over 100 separate configurations in nylon, polypropylene, polycarbonate and PVDF, with other engineering resins available on special order. Available barbed fitting styles include straight tube connectors, elbow fittings, tee fittings, crosses, Y (wye) connectors, multi-port connectors, and multiple reducer combinations.

Several barb styles are offered to provide designers the widest range of assembly forces, pull-off resistance and blow-off resistance – without the need for clamps.

Large Multiport Fittings



4PX655 (-6005)

Four-Port Cross Style Manifold with 600 Series Barb, 1/4" (6.4 mm) Tubing ID

4PX6100 (-6005)

Four-Port Cross Style Manifold with 600 Series Barb, 3/4" (19.0 mm) Tubing ID

4PX670 (-6005)

Four-Port Cross Style Manifold with 600 Series Barb, 3/8" (9.5 mm) Tubing ID

4PX6110 (-6005)

Four-Port Cross Style Manifold with 600 Series Barb, 1" (25.4 mm) Tubing ID

4PX680 (-6005)

Four-Port Cross Style Manifold with 600 Series Barb, 1/2" (12.7 mm) Tubing ID

Reference Part Shown: 4PX655

Large Multiport Reducer Fittings

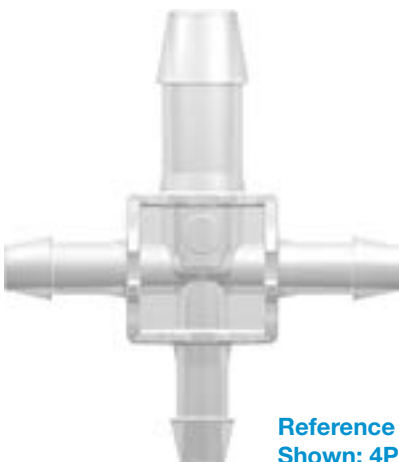

4PX670/655 (-6005)

Four-Port Cross Style Manifold with 600 Series Barb, 3/8" (9.5 mm) and 1/4" x 3 (6.4 mm) Tubing ID

4PX6110/6100 (-6005)

Four-Port Cross Style Manifold with 600 Series Barb, 1" (25.4 mm) and 3/4" x 3 (19.0 mm) Tubing ID

4PX680/670 (-6005)

Four-Port Cross Style Manifold with 600 Series Barb, 1/2" (12.7 mm) and 3/8" x 3 (9.5 mm) Tubing ID

Reference Part Shown: 4PX670/655

Due to size, we are not able to display all large tube fittings. Please see www.nordsonmedical.com for part reference. Minimum package quantities vary by tube IDs. Please verify minimum package sizes when placing orders.

Press-In Plugs



Reference Part Shown: **PIP240**

PIP10 (-1 -6005 -J1A)

Press-In Plug with Classic Series Barb,
1/16" (1.6 mm) Tubing ID

PIP230 (-1 -6005 -6012 -J1A)

Press-In Plug with 200 Series Barb,
1/8" (3.2 mm) Tubing ID

PIP210 (-1 -2)

Press-In Plug with 200 Series Barb,
1/16" (1.6 mm) Tubing ID

PIP40 (-6005 -J1A)

Press-In Plug with Classic Series Barb,
5/32" (4.0 mm) Tubing ID

PIP20 (-6005 -J1A)

Press-In Plug with Classic Series Barb,
3/32" (2.4 mm) Tubing ID

PIP240 (-1 -2)

Press-In Plug with 200 Series Barb,
5/32" (4.0 mm) Tubing ID

PIP220 (-1 -2 -6005 -6012 -J1A)

Press-In Plug with 200 Series Barb,
3/32" (2.4 mm) Tubing ID

PIP50 (-1 -6005 -J1A)

Press-In Plug with Classic Series Barb,
3/16" (4.8 mm) Tubing ID

PIP30 (-1 -6005 -J1A)

Press-In Plug with Classic Series Barb,
1/8" (3.2 mm) Tubing ID

PIP60 (-6005 -J1A)

Press-In Plug with Classic Series Barb,
1/4" (6.4 mm) Tubing ID

TUBE

Fittings

Nordson MEDICAL offers barbed tubing fittings and tubing connectors in sizes ranging from 1/16" (1.6 mm) to 1" (25.4 mm) tubing ID in over 100 separate configurations in nylon, polypropylene, polycarbonate and PVDF, with other engineering resins available on special order. Available barbed fitting styles include straight tube connectors, elbow fittings, tee fittings, crosses, Y (wye) connectors, multi-port connectors, and multiple reducer combinations.

Several barb styles are offered to provide designers the widest range of assembly forces, pull-off resistance and blow-off resistance – without the need for clamps.

Large Press-In Plugs



Reference Part Shown: **PIP080**

PIP070 (-6005)

Press-In Plug with 500 Series Barb,
3/8" (9.5 mm) Tubing ID

PIP680 (-6005)

Press-In Plug with 600 Series Barb,
1/2" (12.7 mm) Tubing ID

PIP670 (-6005)

Press-In Plug with 600 Series Barb,
3/8" (9.5 mm) Tubing ID

PIP6100 (-6005)

Press-In Plug with 600 Series Barb,
3/4" (19.0 mm) Tubing ID

PIP080 (-6005)

Press-In Plug with 500 Series Barb,
1/2" (12.7 mm) Tubing ID

PIP6110 (-6005)

Press-In Plug with 600 Series Barb,
1" (25.4 mm) Tubing ID

Ultrasonically Weldable Barb



Reference Part Shown: **U30**

U10 (-1 -2 -9)

Ultrasonically Weldable Fitting to Classic
Series Barb, 1/16" (1.6 mm) Tubing ID

U30 (-1 -7)

Ultrasonically Weldable Fitting to Classic
Series Barb, 1/8" (3.2 mm) Tubing ID

U20 (-1 -7)

Ultrasonically Weldable Fitting to Classic
Series Barb, 3/32" (2.4 mm) Tubing ID

Due to size, we are not able to display all large tube fittings. Please see www.nordsonmedical.com for part reference. Minimum package quantities vary by tube IDs. Please verify minimum package sizes when placing orders.

Panel Mounts



Reference Part Shown: **PMS230-210**

PMK210 (-1 -6005)

Panel Mount Connector 10-32 UNF to 200 Series Barb, 1/16" (1.6 mm) Tubing ID

PMK220 (-1 -6005)

Panel Mount Connector 10-32 UNF to 200 Series Barb, 3/32" (2.4 mm) Tubing ID

PMS230 (-1 -6005)

Panel Mount Connector 1/4-28 UNF to 200 Series Barb, 1/8" (3.2 mm) Tubing ID

PMS230-210 (-1 -6005 -J1A)

Panel Mount Reduction Connector 1/4-28 UNF to 200 Series Barb, 1/8" (3.2 mm) and 1/16" (1.6 mm) Tubing ID

PMS230-220 (-6005)

Panel Mount Reduction Connector 1/4-28 UNF to 200 Series Barb, 1/8" (3.2 mm) and 3/32" (2.4 mm) Tubing ID

Panel Mount Accessories



Reference Part Shown: **CCR**

CCR (-1 -2 -3 -07)

Color Coded Ring (For Use with PMS, PMK, FTLLB or FTLB Panel Mount Fittings)

CCLR (-1 -2 -3 -4 -5 -06 -07)

Color Coded Lock Ring (For Use with PMS, PMK, FTLLB or FTLB Panel Mount Fittings)

PMKN (-XO)

Panel Mount Nut 10-32 UNF with 3/8" Hex (For Use with PMK Panel Mount Fittings)

PMSN (-XO)

Panel Mount Nut 1/4-28 UNF with 7/16" Hex (For Use with PMS, FTLB or FTLLB Panel Mount Fittings)

LNS (-1 -2 -3 -4 -5 -06 -07 -J1A)

1/4-28 UNF Panel Mount Lock Nut (For Use with PMS, FTLB or FTLLB Panel Mount Fittings)

LUER

Fittings

Nordson MEDICAL's luer tapers are made to the ISO 594-1 and ISO 594-2 standards, and may be connected to other luers meeting these ISO standards. Please test your application to verify the performance of the interconnection. Nordson MEDICAL's luer fittings come in over 100 configurations and several materials for the device designer, joining tubing from 1/16" (1.6 mm) ID to 1/4" (6.4 mm) ID.

Due to space considerations, we only show a subset of our luer product family. To see the full line, please visit www.nordsonmedical.com.



MLRL055 (-1 -6005 -9)

Male Luer to 500 Series Barb, 1/4" (6.4 mm) Tubing ID
(May be used with separate rotating lock ring: FSLLR)



MSL055 (-9)

Male Luer to 500 Series Barb, 1/4" (6.4 mm) Tubing ID



MTLL055 (-1 -2 -3 -4 -06 -6005 -9 -9002)

Male Luer Integral Lock Ring to 500 Series Barb,
1/4" (6.4 mm) Tubing ID



MTLL360 (-1 -6005 -9 -9002 -J1A)

Male Luer Integral Lock Ring to 300 Series Barb,
1/4" (6.4 mm) Tubing ID



FSLLR (-1 -2 -3 -4 -5 -06 -6005 -6012 -07 -9 -9002)

Finger Snap Luer Lock Ring



FTLL055 (-1 -2 -3 -4 -6005 -07 -9 -9002)

Female Luer Thread Style to 500 Series Barb,
1/4" (6.4 mm) Tubing ID



FTLL360 (-1 -5 -6005 -9 -9002 -J1A)

Female Luer Thread Style to 300 Series Barb,
1/4" (6.4 mm) Tubing ID

Features & Benefits:

- Published ISO design standard
 - Well understood worldwide
 - Often assures interconnections without the need to retrofit
- Rotating lock permits tube positioning prior to tightening
 - Minimizes twisting & kinking of tubing
- Tapered cone seal
- Available In several materials & configurations
- Inexpensive & easy to use

Specifications:

Tubing Sizes:

- 1/16" (1.6 mm) to 1/4" (6.4 mm)

Standards Compliant:

- ISO 594-1 and ISO 594-2 standards

It's a Lock with Nordson MEDICAL!

Our MLRL and MLSL Series of fittings can be used both as a slip luer or as a locking luer with the addition of our FSLLR luer lock ring, which allows color coding without flow path contact. Our MLSL/FSLLR combination results in a stationary lock ring. Use a combination of MLRL and FSLLR to create a color coded rotating lock ring.



Looking for Something Different?

Most of our best product ideas have come from you, our customers. While we pride ourselves on our extensive product offering, we recognize that your needs are ever-changing and that our products, too, must adapt to your needs.

If there's a new product you think Nordson MEDICAL should make, please send us an email at designcenter@nordsonmedical.com describing your product concept in as much detail as you desire. We will contact you with any questions, and who knows - the next catalog edition could include products YOU told us to build.

NV Series

Needlefree Swabable Valves

Nordson MEDICAL offers cost efficient needlefree swabable valves featuring higher flow rates, low priming volumes, and a straight through design for unobstructed flow. The valves don't require caps, and the septum surface can be easily disinfected. Designed for the injection and aspiration of fluids, particularly for sampling applications, the hermetic septum seal reduces the risk of biofilm formation and contamination. Available in widely used polycarbonate and copolyester materials, these valves are compatible with industry standard luer syringes and connectors, validating them as an efficient component solution for the OEM market.



NVFMLLCP

Swabable Straight Valve, Female Luer to Male Luer Lock, Copolyester



NVFMLLPC

Swabable Straight Valve, Female Luer to Male Luer Lock, Polycarbonate



NVFMLLS-001

Swabable Straight Valve, Female Luer to Male Luer Lock, Polycarbonate



NV FY401CP

Swabable 'Y' Valve, Female Luer Y Port to 4.01 mm Tube Sockets, Copolyester



NV FY401PC

Swabable 'Y' Valve, Female Luer Y Port to 4.01 mm Tube Sockets, Polycarbonate



NV FY42S-001

Swabable 'Y' Valve, Female Luer Y Port to 4.2 mm Bondable Sockets, Polycarbonate

Features & Benefits:

- Valve stems & bodies securely mate with standard luer syringes & connectors
- Several configurations that are easy to customize
- Normally closed system to reduce the risk of infection
- Low priming volume & high flow rates
- Straight through design for unobstructed flow
- Gamma radiation stable & EtO compatible
- Not made with natural rubber latex or DEHP

Non-Sterile Medical Device:

The NV Series products are shipped bulk, non-sterile and are single use components requiring further processing (e.g. assembly, packaging, sterilization) before clinical use. The buyer is responsible for determining effects of processing/multiple usage on these components, appropriateness of the component in the final application, and pre/post shelf life.



NVFMLPC

Bondable Valve, Female Luer to Male Luer Slip, Polycarbonate



NVFMLPCB

Bondable Valve, Female Luer to Male Luer Slip, Blue Cap, Polycarbonate



NVFBGPC

Swabable Bag Valve, Female Luer to Bag Access Port, Polycarbonate



NVFBV60PC

Swabable Break-Off Valve, Female Luer to Break Off 6.0 mm Port, Polycarbonate



NVF13VPC

13 mm Swabable Vial Cap, Female Luer to 13 mm Vial Cap, Polycarbonate



NVM41S-001

Valved Male Luer to 4.0/4.1 mm Bondable Socket, Polycarbonate

SCV Series

Single Check Valves

SCV Series check valves control directional flow to help prevent backflow. Products are available in several configurations, materials, and end fittings. The valves feature low priming volume, ease of removing air bubbles during priming and operate in any spatial orientation. All products feature DEHP- and latex-free silicone diaphragms and all materials of construction satisfy USP Class VI and ISO 10993 criteria. SCV Series products are offered in three different materials, MABS, SAN and polycarbonate, all featuring a patented silicone diaphragm. Several different end fittings are available, including tubing pockets, tubing sockets and male and female luer fitting ends.



SCV06252

Check Valve, Female Locking Luer to Male Locking Luer, Clear Transparent SAN and Blue Transparent SAN with Silicone Diaphragm
 Cracking Pressure: 2.9 +/- 0.725 psig
 Max. Back Pressure: 304.5 psig
 Flow Rate with Glucose: \geq 150 ml/min



SCV23050

Check Valve, Female Locking Luer to Male Locking Luer, Clear SAN with Silicone Diaphragm
 Cracking Pressure: \leq .174 psig
 Max. Back Pressure: 87.023 psig
 Flow Rate: \geq 90 ml/min



SCV06397

High Flow Check Valve, Pocket for .346" (8.8 mm) OD Tubing to Pocket for .346" (8.8 mm) OD Tubing, Clear MABS with Silicone Diaphragm
 Cracking Pressure: \leq .290 psig
 Max. Back Pressure: 14.500 psig
 Flow Rate: \geq 1000 ml/min



VPS5401068N

Check Valve, Male/Female Luer, 1/4 psi Inlet Cracking Pressure, Polycarbonate with Silicone Disc
 Max. Back Pressure: 30 psig
 Flow Rate: 420 ml/min at 1 M head



SCV06398

High Flow Check Valve, Pocket for .268" (6.8 mm) OD Tubing to Pocket for .268" (6.8 mm) OD Tubing, Clear MABS with Silicone Diaphragm
 Cracking Pressure: \leq .290 psig
 Max. Back Pressure: 14.500 psig
 Flow Rate: \geq 1000 ml/min



VPS5401036SN

Reflux Check Valve, Male/Female Luer, opens at 284 mmHg, Polycarbonate with Silicone Disc
 Max. Back Pressure: 45 psig
 Flow Rate: 350 ml/min at 1 M head

DCV Series

Double Check Valves

Nordson MEDICAL's unique DCV Series bi-directional double check valve is designed to transfer clean fluid from a supply vessel to a use site. The fluid supply vessel is connected to the valve supply port (chimney) using a luer connection or tubing. The fluid is withdrawn from the supply vessel by a syringe or other device connected to the aspiration port. When the syringe is compressed the fluid is then transferred, through the exit port, to the use site without adulterating the fluid. DCV Series bi-directional valves are produced in polycarbonate resin using a silicone diaphragm, with two available inlet ports connecting to the female luer aspiration and male luer discharge ports.



DCV115

Double Check Valve, Tubing Pocket Chimney Port, Rotating Luer Lock Exit Port, Radiation-Stable Polycarbonate with Biomed Grade Silicone Diaphragm, Cracking Pressure: 2-5 psi

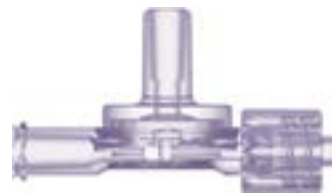

DCV125

Double Check Valve, Female Luer Chimney Port, Rotating Luer Lock Exit Port, Radiation-Stable Polycarbonate with Biomed Grade Silicone Diaphragm, Cracking Pressure: 2-5 psi

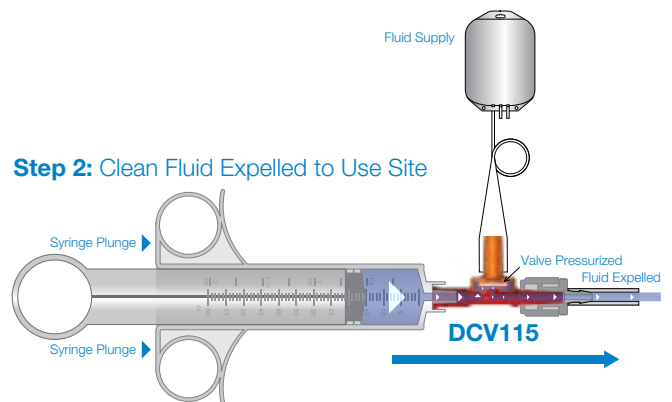
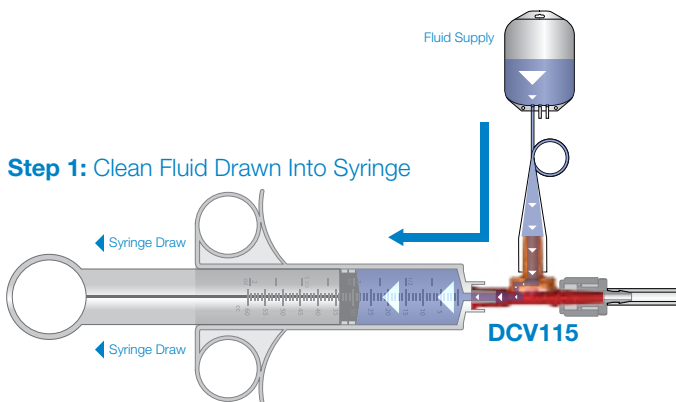

SCV Series

Barbed Check Valves

SCV Series barbed check valves were developed to provide a reliable mechanical connection and simplify tubing assemblies that often require multiple parts needed for in-line check valves. The valves feature 3/32" (2.4 mm) and 1/8" (3.2 mm) single barb ends in barb to barb straight through, reducing, and barb to male/female luer configurations. Barbed check valves reduce the risk of contamination and feature more precise, lower crack pressures and higher flow rates. They are ideal for medical device designers focused on bioprocessing, infusion, drainage and irrigation applications.



SCV67220

Check Valve, 200 Series Barbs, 3/32" (2.4 mm) ID Tubing x 3/32" (2.4 mm) ID Tubing, White and Clear MABS with Silicone Diaphragm

Cracking Pressure: $\leq .087$ psig
Max. Back Pressure: 73 psig
Flow Rate: ≥ 150 ml/min



SCV67FL/220

Check Valve, 200 Series Barb, 3/32" (2.4 mm) ID Tubing x Female Luer Thread Style, White SAN and Clear MABS with Silicone Diaphragm

Cracking Pressure: $\leq .087$ psig
Max. Back Pressure: 73 psig
Flow Rate: ≥ 150 ml/min



SCV67220/230

Check Valve, 200 Series Barbs, 3/32" (2.4 mm) ID Tubing x 1/8" (3.2 mm) ID Tubing, White and Clear MABS with Silicone Diaphragm

Cracking Pressure: $\leq .087$ psig
Max. Back Pressure: 73 psig
Flow Rate: ≥ 150 ml/min



SCV67220/ML

Check Valve, Male Locking Luer x 200 Series Barb, 3/32" (2.4 mm) ID Tubing, White SAN and Clear MABS with Silicone Diaphragm

Cracking Pressure: $\leq .087$ psig
Max. Back Pressure: 73 psig
Flow Rate: ≥ 150 ml/min

Features & Benefits:

- Materials meet USP Class VI and ISO 10993 criteria
- DEHP- and latex-free silicone diaphragms
- All products are suitable for EtO or gamma sterilization
- Several connection configurations and materials
- Air bubbles completely removable during priming
- Operate in any spatial orientation

Specifications:

Materials:

- Housing - MABS and SAN
Diaphragm - Latex-Free Silicone

Cracking Pressure:

- ≤ 6 mBar ($\leq .087$ psig)

Max. Back Pressure:

- 5 Bar (73 psig)

Flow Rate (Water):

- ≥ 150 ml/min ($\geq .0396$ gal/min)



SCV67230

Check Valve, 200 Series Barbs, 1/8" (3.2 mm) ID Tubing x 1/8" (3.2 mm) ID Tubing, White and Clear MABS with Silicone Diaphragm

Cracking Pressure: $\leq .087$ psig
Max. Back Pressure: 73 psig
Flow Rate: ≥ 150 ml/min



SCV67FL/230

Check Valve, 200 Series Barb, 1/8" (3.2 mm) ID Tubing x Female Luer Thread Style, White SAN and Clear MABS with Silicone Diaphragm

Cracking Pressure: $\leq .087$ psig
Max. Back Pressure: 73 psig
Flow Rate: ≥ 150 ml/min



SCV67230/220

Check Valve, Barb for 1/8" (3.2 mm) x 3/32" (2.4 mm) ID Tubing, White and Clear MABS with Silicone Diaphragm

Cracking Pressure: $\leq .087$ psig
Max. Back Pressure: 73 psig
Flow Rate: ≥ 150 ml/min



SCV67230/ML

Check Valve, Male Locking Luer x 200 Series Barb, 1/8" (3.2 mm) ID Tubing, White SAN and Clear MABS with Silicone Diaphragm

Cracking Pressure: $\leq .087$ psig
Max. Back Pressure: 73 psig
Flow Rate: ≥ 150 ml/min



DIVERT™ STOPCOCKS

Nordson MEDICAL's Divert™ Stopcocks are designed to easily control the flow of a liquid or gas through the use of an on/off diverter, and are available in high, medium, and low pressure configurations as well as some high flow options. With three basic styles — 1-way, 3-way, and 4-way, Divert™ Stopcocks are offered in polycarbonate, PEI and nylon with HDPE, acetal, or POM diverters. Divert™ Stopcocks bring efficiency, convenience, and practicality to your tubing applications. Nordson MEDICAL also offers custom solutions, including manifolds, ganged manifolds, and tubing assemblies.



FCHPFFMR-003
3-Way High Pressure Stopcock, Female Luer to Female Luer to Male Luer with Luer Lock Ring, Clear Polycarbonate Body and Lock Ring, 4-Arrow Gold Color Acetal Diverter



FCHPFFMR-002
3-Way High Pressure Stopcock, Female Luer to Female Luer to Male Luer with Luer Lock Ring, Clear Polycarbonate Body and Lock Ring, 4-Arrow Grey Color Acetal Diverter



FCHPFMR-003
1-Way High Pressure Stopcock, Female Luer to Male Luer with Luer Lock Ring, Clear Polycarbonate Body and Lock Ring, 2-Arrow Gold Color Acetal Diverter



FC4FFMR-001
4-Way Stopcock, Female Luer to Female Luer to Male Luer with Luer Lock Ring, Natural Nylon Body, Tinted Polycarbonate Lock Ring, 1-Arrow White HDPE Diverter



FCHPFFMR-001
3-Way High Pressure Stopcock, Female Luer to Female Luer to Male Luer with Luer Lock Ring, Clear Polycarbonate Body and Lock Ring, 4-Arrow Gold Color Acetal Diverter



FCHPFMR-002
1-Way High Pressure Stopcock, Female Luer to Male Luer with Luer Lock Ring, Clear Polycarbonate Body and Lock Ring, 2-Arrow Gold Color Acetal Diverter



FCHPFMR-005
1-Way High Pressure Stopcock, Female Luer to Male Luer with Luer Lock Ring, Clear Polycarbonate Body and Lock Ring, 2-Arrow Grey Color Acetal Diverter



FCFFM-002
3-Way Stopcock, Female Luer to Female Luer to Bondable Socket, Clear Polycarbonate Body, 1-Arrow Red Color HDPE Diverter

Features & Benefits:

- Multiple configurations: high pressure, medium pressure, low pressure, and high flow
- Styles: 1-way, 3-way, and 4-way
- Chemically resistant options
- Not made with DEHP
- Diverter arrows that provide a clear indication of flow
- Custom solutions: manifolds, ganged manifolds, and tubing assemblies

Specifications:

Flow Options:

- Standard flow
- High flow

Materials:

- Polycarbonate
- PEI
- Nylon
- Acetal
- HDPE
- POM



FCFFM-003

3-Way Stopcock, Female Luer to Female Luer to Bondable Socket, Clear Polycarbonate Body, 1-Arrow Natural HDPE Diverter



FCFFM-009

3-Way Stopcock, Female Luer to Female Luer to Male Luer, Tinted Polycarbonate Body, 1-Arrow White HDPE Diverter



FCFFM-013

3-Way Stopcock, Female Luer to Female Luer to Male Luer, Tinted Polycarbonate Body, 1-Arrow Natural HDPE Diverter



FCFFMR-003

3-Way Stopcock, Female Luer to Female Luer to Male Luer with Luer Lock Ring, Polycarbonate Body and Lock Ring, 1-Arrow Natural HDPE Diverter



FCFFM-008

3-Way Stopcock, Female Luer to Female Luer to Male Luer, Clear Polycarbonate Body, 1-Arrow Natural HDPE Diverter



FCFFM-010

3-Way Stopcock, Female Luer to Female Luer to Male Luer, Clear Polycarbonate Body, 1-Arrow Natural HDPE Diverter



FCFFMR-002

3-Way Stopcock, Female Luer to Female Luer to Male Luer with Luer Lock Ring, Tinted Polycarbonate Body and Lock Ring, 1-Arrow White HDPE Diverter



FCFFMR-004

3-Way Stopcock, Female Luer to Female Luer to Male Luer with Luer Lock Ring, Clear Polycarbonate Body and Lock Ring, 1-Arrow Natural HDPE Diverter



DIVERT™ STOPCOCKS

Nordson MEDICAL's Divert™ Stopcocks are designed to easily control the flow of a liquid or gas through the use of an on/off diverter, and are available in three basic configurations – 1-way, 3-way, and 4-way. These chemically resistant stopcocks are available as standard or high flow and are offered in polycarbonate, PEI and nylon with HDPE diverters.

Divert™ Stopcocks bring efficiency, convenience, and practicality to your tubing applications. Nordson MEDICAL also offers custom solutions, including manifolds, ganged manifolds, and tubing assemblies.



FCFM-001

1-Way Stopcock, Female Luer to Male Luer, Clear Polycarbonate Body, 2-Arrow Natural HDPE Diverter



FCFM-002

1-Way Stopcock, Female Luer to Male Luer, Clear Polycarbonate Body, 2-Arrow Blue HDPE Diverter



FCFM-006

1-Way Stopcock, Female Luer to Male Luer, Tinted Polycarbonate Body, 2-Arrow Natural HDPE Diverter



FCFM-010

1-Way Stopcock, Female Luer to Male Luer, Tinted Polycarbonate Body, 2-Arrow Natural POM Diverter



FCFMR-001

1-Way Non-Sterile Stopcock, Female Luer to Male Luer with Luer Lock Ring, Clear Polycarbonate Body, 2-Arrow Natural HDPE Diverter



FC4LB3F-001

4-Way Stopcock, Female Luer on All Ports, Large Bore, Tinted Polycarbonate Body, 1-Arrow White HDPE Diverter

Features & Benefits:

- Multiple configurations:
1-way, 3-way, 4-way
- Chemically resistant
- Not made with DEHP
- Diverter arrows that provide a clear indication of flow
- Custom solutions available, including manifolds, ganged manifolds, and tubing assemblies

Specifications:

Flow Options:

- Standard flow
- High flow

Materials:

- Polycarbonate
- PEI
- Nylon
- HDPE



FCLBFFM-001

3-Way High Flow Stopcock, Female Luer to Female Luer to Male Luer, Large Bore, Natural Nylon Body, 1-Arrow White HDPE Diverter



FCLBFFM-1A-003

3-Way High Flow Stopcock, Female Luer to Female Luer to Male Luer, Large Bore, Clear Polycarbonate Body, 1-Arrow Natural HDPE Diverter



FCLBFFM-003

3-Way High Flow Stopcock, Female Luer to Female Luer to Bondable Socket, Large Bore, Clear Polycarbonate Body, 1-Arrow Natural HDPE Diverter



FCLBFFMR-1A-003

3-Way High Flow Stopcock, Female Luer to Female Luer to Male Luer with Luer Lock Ring, Large Bore, Clear Polycarbonate Body and Lock Ring, 1-Arrow Natural HDPE Diverter



FCLBFMR-001

1-Way High Pressure Stopcock, Female Luer to Male Luer with Luer Lock Ring, Large Bore, Clear Polycarbonate Body and Lock Ring, 2-Arrow Natural HDPE Diverter

SILICONE

Tubing

50 Shore A

Our silicone tubing is extruded from a low-volatile grade, platinum-cured compound that is ideal for critical applications in pharmaceutical, biotech, medical, food, and beverage industries.

Part Drawings Online!

Nordson MEDICAL provides dimensional drawings available for download for all of its fittings.
www.nordsonmedical.com

Technical Assistance

Trying to choose the correct part? Need more material information than is published in this catalog? Call Nordson MEDICAL Technical Support at (970) 267-5200.

Resin Grade & Technical Information:

This tubing is extruded and packaged in a Class 7 (Class 10,000) ISO-certified clean room. It has undergone extensive physical, chemical, and biological testing and meets USP Class VI, FDA CFR 177.2600, ISO 10993, European Pharmacopoeia 3.1.9, and 3-A standards. It is certified free of animal-derived ingredients and is certified by the National Sanitation Foundation for use in food equipment materials (NSF-51). It offers a temperature range use of -100°F (-73.3°C) to 400°F (204.4°C) and is sterilizable by autoclave or gamma irradiation.



Dimensions (ID X OD X LGTH)

SILC7001098	1/16" X 1/8" X 50'
SILC7001422	1/16" X 3/16" X 500'
SILC7001424	1/8" X 1/4" X 500'
SILC7001657	1/8" X 1/4" X 50'
SILC7001839	5/32" X 9/32" X 100'
SILC7002203	1/4" X 3/8" X 50'
SILC7003139	3/4" X 1" X 50'

TPE

Tubing

65 Shore A

Our Biopharmaceutical-grade thermoplastic elastomer (TPE) tubing is sterile weldable, heat sealable, moldable, and offers excellent life in peristaltic pumps. It is ideal for use in single-use processes for sampling, filling, and storage tubing set assemblies.

Resin Grade & Technical Information:

This tubing is made from FDA-approved ingredients, certified free of silicone oils and animal derived ingredients, and is sterilizable by autoclave or gamma irradiation. It meets various ISO and USP standards, including Class VI, as well as European Pharmacopoeia 3.2.2.1. It also offers excellent low absorption and permeability as compared to silicone tubing.



AF7500753

Dimensions (ID X OD X LGTH)

3/4" X 1" X 50'

Custom Assembly

We produce standard components to fit your current assemblies and devices, but we also provide custom solutions by applying a variety of assembly options, such as joining fittings, connectors, filters, and other components to tubing. From systems using a single fitting to complex configurations utilizing various components, we can design complete assemblies to your requirements.

INDEX

The bioprocessing market demands that suppliers be able to assure quality, streamline processes, and limit costs. Nordson MEDICAL makes certain that you receive the preeminent and safest single-use components available to your business.

3PF210	46	5050.....	29
3PF220	46	5060.....	33
3PF230	46	6060.....	29
4PDL220	46	AA.....	28
4PLL210	46	AC.....	31
4PLL220	47	AD.....	31
4PLL230	47	Bag Ports	24
4PX210	46	Barbed Check Valves	58
4PX220	46	BioClamp®	14
4PX230	46	BioValve®	15
4PX655	48	CC	28
4PX670	48	CCLR	51
4PX670/655	48	CCR	51
4PX680	48	CF494	37
4PX680/670	48	CPAN75	10, 11
4PX6100	48	CPAX150.....	10, 11
4PX6110	48	CPN75	11
4PX6110/6100.....	48	CPT90.....	12
6PDT220.....	47	CPT100.....	12
6PDT230.....	47	CPT110.....	13
6PTT230	47	CPX150.....	11
1040.....	32	CYLINDRAFlow™ Manifolds	21
1050.....	32	DC.....	31
2040.....	32	DCV115	57
2050.....	32	DCV125	57
3040.....	32	DD.....	28
3050.....	32	Divert™ Stopcocks	60
3060.....	33	Double Check Valves.....	57
4040.....	29	Easy-Open Clamps	10
4050.....	32	Elbow Fittings	36
4060.....	33	Elbow Reducer Fittings.....	38

Find the part numbers that enable you to select the most appropriate products for your particular application.

FC4FFMR-001	60	G40MPGR-TF150	22
FC4LB3F-001	62	G40RX-PX-0400	23
FCFFM-002	60	G424TRX-0300	22
FCFFM-003	61	Gaskets	22
FCFFM-008	61	GM4749TRX-0600	23
FCFFM-009	61	GMN450	22
FCFFM-010	61	GMX455	22
FCFFM-013	61	L10	36
FCFFMR-002	61	L20	36
FCFFMR-003	61	L30	36
FCFFMR-004	61	L40	36
FCFM-001	62	L50	36
FCFM-002	62	L60	36
FCFM-006	62	L70	37
FCFM-010	62	L070/055	38
FCFMR-001	62	L080	37
FCHPFFMR-001	60	L080/070	38
FCHPFFMR-002	60	L090	37
FCHPFFMR-003	60	L100	37
FCHPFMR-002	60	L100/080	38
FCHPFMR-003	60	L110	37
FCHPFMR-005	60	L110/100	38
FCLBFFM-001	63	L210	36
FCLBFFM-1A-003	63	L220	36
FCLBFFM-003	63	L220/210	38
FCLBFFMR-1A-003	63	L230	36
FCLBFMR-001	63	L230/210	38
FMD5P670-001	21	L230/220	38
FSLLR	52	L410	36
FTLL055	52	L420	36
FTLL360	52	L420/410	38

INDEX

The bioprocessing market demands that suppliers be able to assure quality, streamline processes, and limit costs. Nordson MEDICAL makes certain that you receive the preeminent and safest single-use components available to your business.

L430.....	36	N025/004.....	32
L430/420.....	38	N025/007.....	32
L440.....	36	N025/013.....	32
L6110.....	37	N035.....	29
Large Elbow Fittings.....	37	N035/007.....	32
Large Elbow Reducer Fittings.....	38	N035/013.....	32
Large Multiport Fittings.....	48	N035/025.....	33
Large Multiport Reducer Fittings.....	48	N055.....	29
Large Press-In Plugs.....	50	N055/013.....	33
Large Straight Through Fittings.....	30	N055/025.....	33
Large Straight Through Reducer Fittings.....	34	N055/035.....	33
Large Tee Fittings.....	40	N065.....	29
Large Tee Reducer Fittings.....	43	N065/025.....	33
Large Y Fittings.....	45	N065/035.....	33
Large Y Reducer Fittings.....	45	N065/055.....	33
LNS.....	51	N070.....	30
Luer Fittings.....	52	N070/013.....	34
Maxi Flange.....	17	N070/055.....	34
Mini Flange.....	16	N080.....	30
MLRL055.....	52	N080/055.....	34
MSL055.....	52	N080/070.....	34
MTLL055.....	52	N090.....	30
MTLL360.....	52	N090/055.....	34
Multiport Fittings.....	46	N090/070.....	34
N004.....	28	N100.....	30
N007.....	28	N100/080.....	35
N007/004.....	31	N110.....	30
N013.....	28	N110/100.....	35
N013/004.....	31	N210.....	28
N013/007.....	31	N220.....	28
N025.....	29	N220/210.....	31

Find the part numbers that enable you to select the most appropriate products for your particular application.

N230	28	NVFMLLS-001	54
N230/210	31	NVFMMLPC	55
N230/220	31	NVFMMLPCB	55
N410	28	NVfy42S-001	54
N420	28	NVfy401CP	54
N420/410	31	NVfy401PC	54
N430	28	NVM41S-001	55
N430/410	31	Opposing Barb Ports	26
N430/420	31	Panel Mount Accessories	51
N440	29	Panel Mounts	51
N670	30	PharmaLok™ Clamps	10
N670/630	34	PharmaLok™ Tube Clamps	12
N670/655	34	PIP10	49
N680	30	PIP20	49
N680/655	34	PIP30	49
N680/670	34	PIP40	49
N690	30	PIP50	49
N690/655	34	PIP60	49
N690/670	34	PIP070	50
N6100	30	PIP080	50
N6100/670	35	PIP210	49
N6100/680	35	PIP220	49
N6110	30	PIP230	49
N6110/680	35	PIP240	49
N6110/6100	35	PIP670	50
Needlefree Swabable Valves	54	PIP680	50
NVf13VPC	55	PIP6100	50
NVFBGPC	55	PIP6110	50
NVFBV60PC	55	PMK210	51
NVFMMLCP	54	PMK220	51
NVFMMLPC	54	PMKN	51

INDEX

Nordson MEDICAL prides itself in developing original designs and custom solutions. All products can be customized to meet your specific user requirements, as our experienced engineering and service teams understand today's medical device markets. We are dedicated to exceeding your expectations.

PMS230.....	51	SDAVF655NPS.....	8
PMS230-210.....	51	SDAVF670NPS.....	8
PMS230-220.....	51	SDAVF680NPS.....	9
PMSN.....	51	SDAVM655NPS.....	8
Press-In Plugs.....	49	SDAVM670NPS.....	8
RQCF655.....	6	SDAVM680NPS.....	9
RQCF670.....	6	SFBP630.....	24
RQCFC.....	6	SFBP635/635.....	26
RQCFLC.....	6	SFBP655.....	24
RQCM670.....	6	SFBP655/655.....	26
RQ Series Quick Connects.....	6	SFBP670.....	24
RQXF670.....	7	SFBP670/670.....	26
RQXM670.....	7	SFBP680.....	24
RQXMP.....	7	SFBP680/680.....	27
SCV67FL/220.....	58	SFBP6100.....	24
SCV67FL/230.....	59	SFBP6100/6100.....	27
SCV06252.....	56	SFBP6110.....	24
SCV06397.....	56	SFBPF1.....	25
SCV06398.....	56	SFBPF3.....	25
SCV23050.....	56	SFBPF4.....	25
SCV67220.....	58	SFM3C-6005.....	25
SCV67220/230.....	58	SFM4C-6005.....	25
SCV67220/ML.....	58	SFM100/SFM075.....	18
SCV67230.....	59	SFM150/SFM075.....	18
SCV67230/220.....	59	SFM150/SFM100.....	18
SCV67230/ML.....	59	SFM200/SFM075.....	19
SDAFCNPS.....	9	SFM200/SFM150.....	19
SDAM655NPS.....	8	SFMN630.....	16
SDAM670NPS.....	8	SFMN655.....	16
SDAM680NPS.....	9	SFMN670.....	16
SDAMPNPS.....	9	SFMN680.....	16

Custom Product Development & Design:

- Modular designs that allow for easy customization
- Concept & prototype development capabilities
- Research & development labs
- DFM part design
- CAD files - SolidWorks & FEA
- Solid modeling
- Use of Computational Fluid Dynamics (CFD) software
- 3-D printing & rapid prototyping
- Bench testing
- Verification & validation testing including sterilization, packaging, shelf life, and biocompatibility process validation
- Assembly & packaging
- Private labeling options

SFMN6100.....	16	T055.....	39
SFMNC	16	T60.....	39
SFMX655	17	T070.....	40
SFMX670	17	T070/055	43
SFMX680	17	T080.....	40
SFMX6100	17	T080/055	43
SFMX6110	17	T080/070	43
SFMXC.....	17	T100.....	40
SFMXT680	20	T100/080	43
SFMXT6110	20	T110.....	40
SF Series Instrument Tees	20	T110/100	43
SF Series Sanitary Fitting Reducers	18	T210.....	39
SF Series Sanitary Fittings	16	T210/220	41
SILC7001098	64	T210/230	41
SILC7001422	64	T220.....	39
SILC7001424	64	T220/210	41
SILC7001657	64	T220/230	41
SILC7001839	64	T220R210	41
SILC7002203	64	T230.....	39
SILC7003139	64	T230/210	41
Silicone Tubing	64	T230/220	42
Single Check Valves	56	T230R210	41
Single-Use Clamps.....	11	T230R220	42
Spaulding™ Aseptic Disconnects	8	T250.....	39
Straight Through Fittings.....	28	T360/220	42
Straight Through Reducer Fittings.....	31	T360/230	42
T10.....	39	T360/250	42
T013.....	39	T410.....	39
T20.....	39	T410/420	41
T30.....	39	T410/430	41
T40.....	39	T420.....	39

INDEX

Nordson MEDICAL maintains a comprehensive list of all material and regulatory information, enabling you to select the most appropriate products for your particular application. With a solid reputation for quality, service and reliability, Nordson MEDICAL can provide the detailed support you need from idea to market. Our global regulatory and registration expertise is at your service.

T420/410	41	VNG200WHT	14
T420/430	41	VNG300WHT	14
T420R410	41	VNG400WHT	14
T430.....	39	VNG600WH	14
T430/410	42	VNG800WH	14
T430/420	42	VPS5401036SN	56
T430R410	42	VPS5401068N	56
T430R420	42	Y013	44
T670.....	40	Y055	44
T670/655	43	Y070	45
T680.....	40	Y080	45
T680/655	43	Y090	45
T680/670	43	Y100	45
T690.....	40	Y110	45
T6100.....	40	Y210	44
T6100/670	43	Y220	44
T6100/680	43	Y230	44
T6110.....	40	Y240	44
T6110/6100	43	Y250	44
Tee Fittings	39	Y260	44
Tee Reducer Fittings	41	Y410	44
TPE Tubing.....	65	Y420	44
Tube Fittings	28	Y430	44
U10	50	Y450	44
U20	50	Y460	44
U30	50	Y630/655	45
Ultrasonically Weldable Barb.....	50	Y655/670	45
VBV0500NW	15	Y670	45
VBV1000NW	15	Y670/680	45
VNG075WHT	14	Y680	45
VNG150WHT	14	Y690	45

Contact us to learn more about our bioprocessing capabilities.

TEL: +1 (970) 267-5200

TOLL FREE in USA: (888) 404-5837

www.nordsonmedical.com

Y6100	45
Y6100/6110	45
Y6110	45
Y Fittings	44

About Nordson MEDICAL

Nordson MEDICAL is a global integrated solutions partner with more than 30 years of experience in design, engineering, and manufacturing of complex medical devices and components. Nordson MEDICAL specializes in components and services used in interventional and minimally invasive surgical products including catheters, balloons, extrusions, polyimide and composite tubing, heat shrink tubing, reinforced shafts, cleanroom injection molding, and finished device assembly and packaging. Visit Nordson MEDICAL at nordsonmedical.com.

©Nordson MEDICAL. All rights reserved. **MAR-BIOP-BR Rev. G** 2021-03



Value Plastics, Inc.
dba Nordson MEDICAL
805 West 71st Street
Loveland, CO 80538, USA

Phone: (970) 267-5200
Toll Free: (888) 404-5837

FMF-sales@nordsonmedical.com
www.nordsonmedical.com